

# Einheitsdiesel with small field kitchen Hf. 14











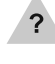

Cat. no. 35007

Scale 1/35

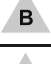

Project, design & artwork: Jarosław Leoniec  
Research: IBG crew

-  Element złożony we wcześniejszym etapie  
*Element assembled in previous step*
-  Element po złożeniu w aktualnym etapie  
*Element after assembly in actual step*
-  Wersja do wyboru  
*Version to choose*
-  Kalkomania  
*Decal*
-  Kolor farby  
*Paint colour*
-  Część nie do użycia  
*Part not for use*

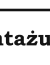
		Gunze Mr.Color	Model Master Acrylic	Humbrol	Valleyo MC
black		C002	4695	21	861
wood		C043	4673	110	846
gunmetal		C104	4681	53	863
panzer gray		C040	4795	67	995
rust		C029	4675	113	846
leather		C019	4674	62	843

Przed montażem przeczytać instrukcję. Przestrzegać kolejności montażu podanego w instrukcji! Klej i farby nie wchodzą w skład zestawu.

*Please read instruction before assembly. Obey sequence of assembly like in instruction. Glue and paints not included.*

## Ramka C / Frame C

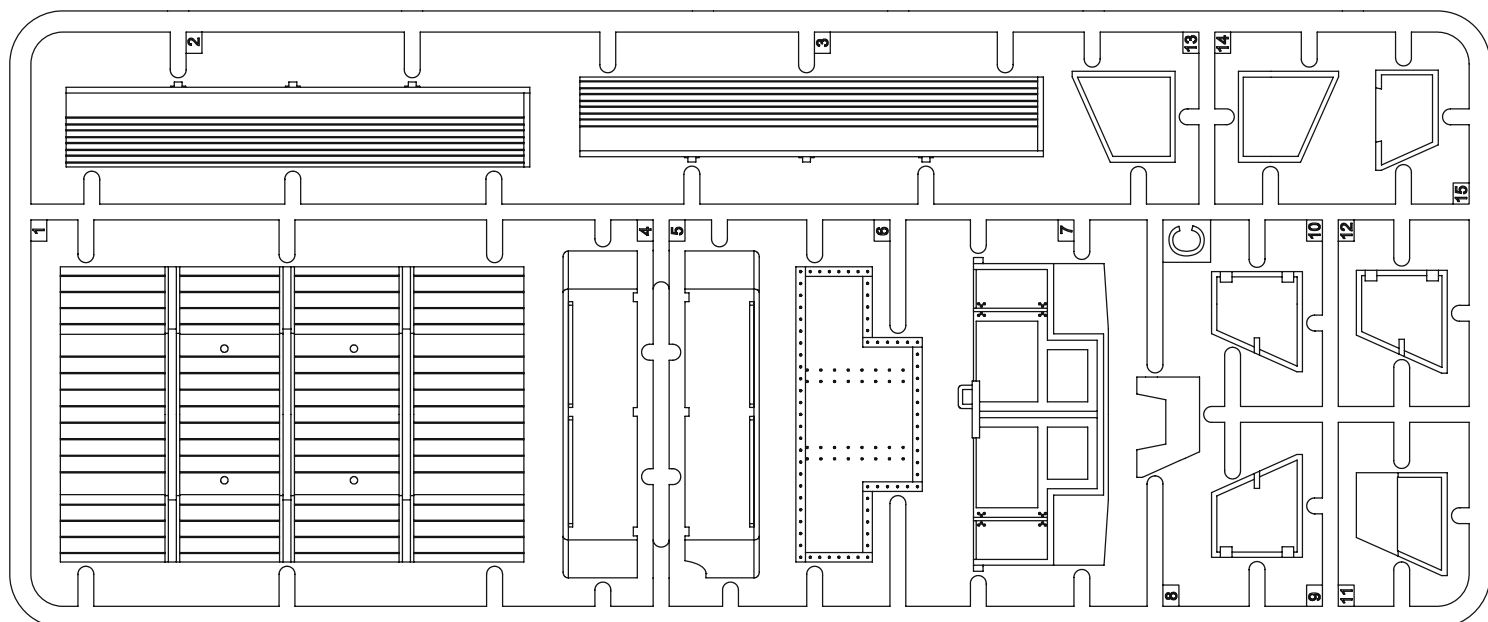

# Ramka X / Frame X

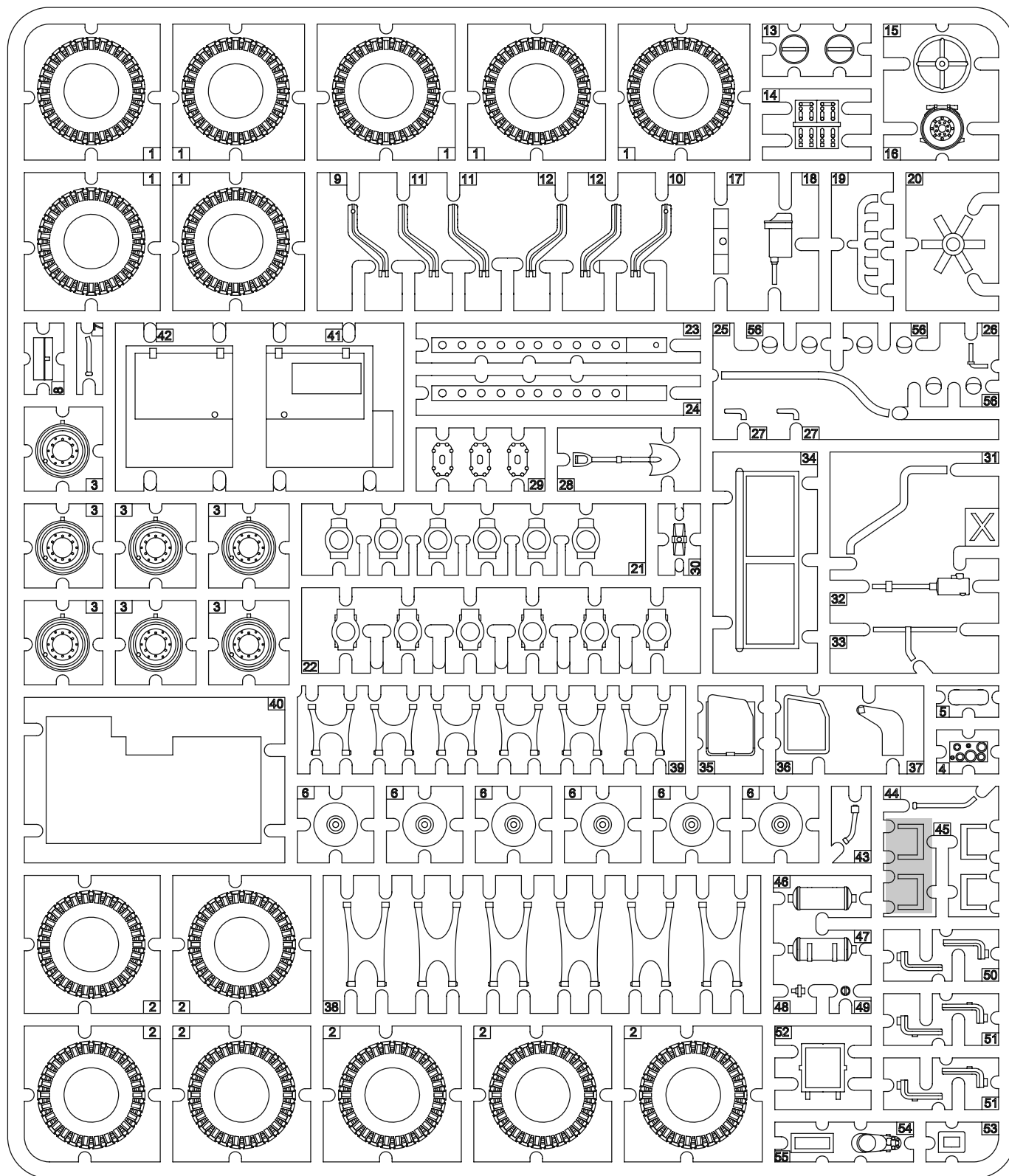

## Ramka Y / Frame Y

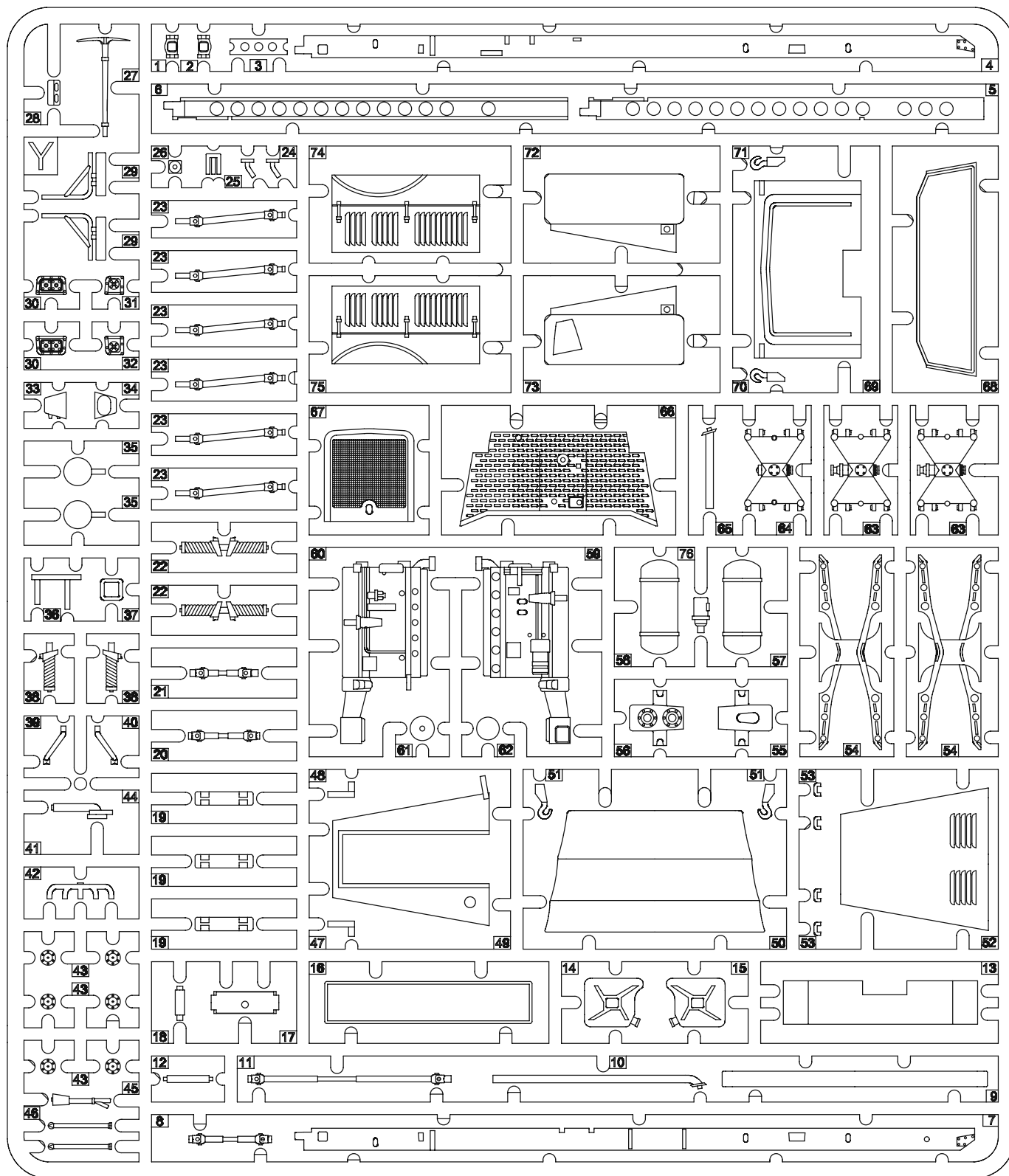

## Ramka przezroczysta / Frame clear

Ramki K i E / Frames K & E

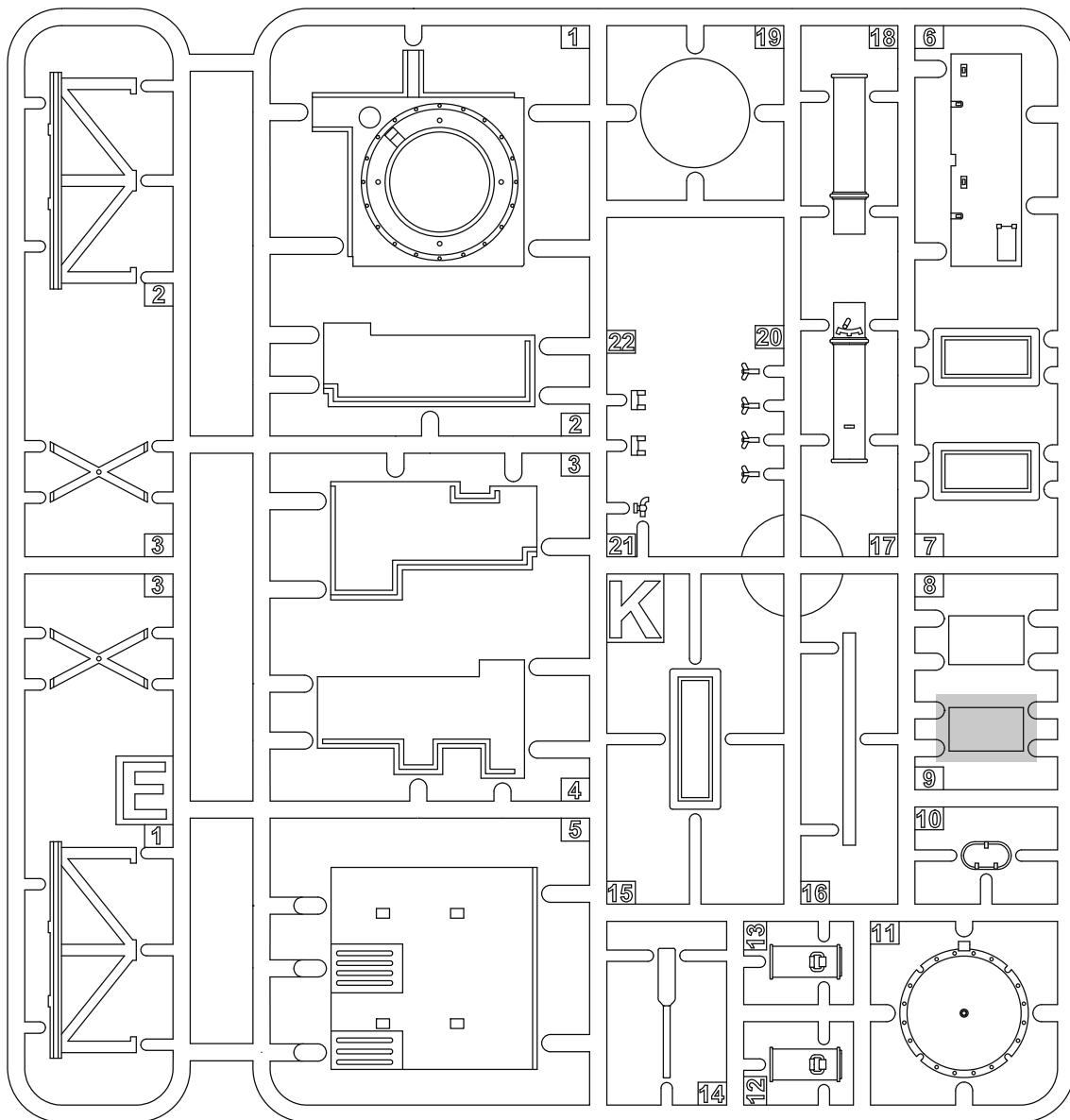

**ETAP 1**  
**STEP 1**

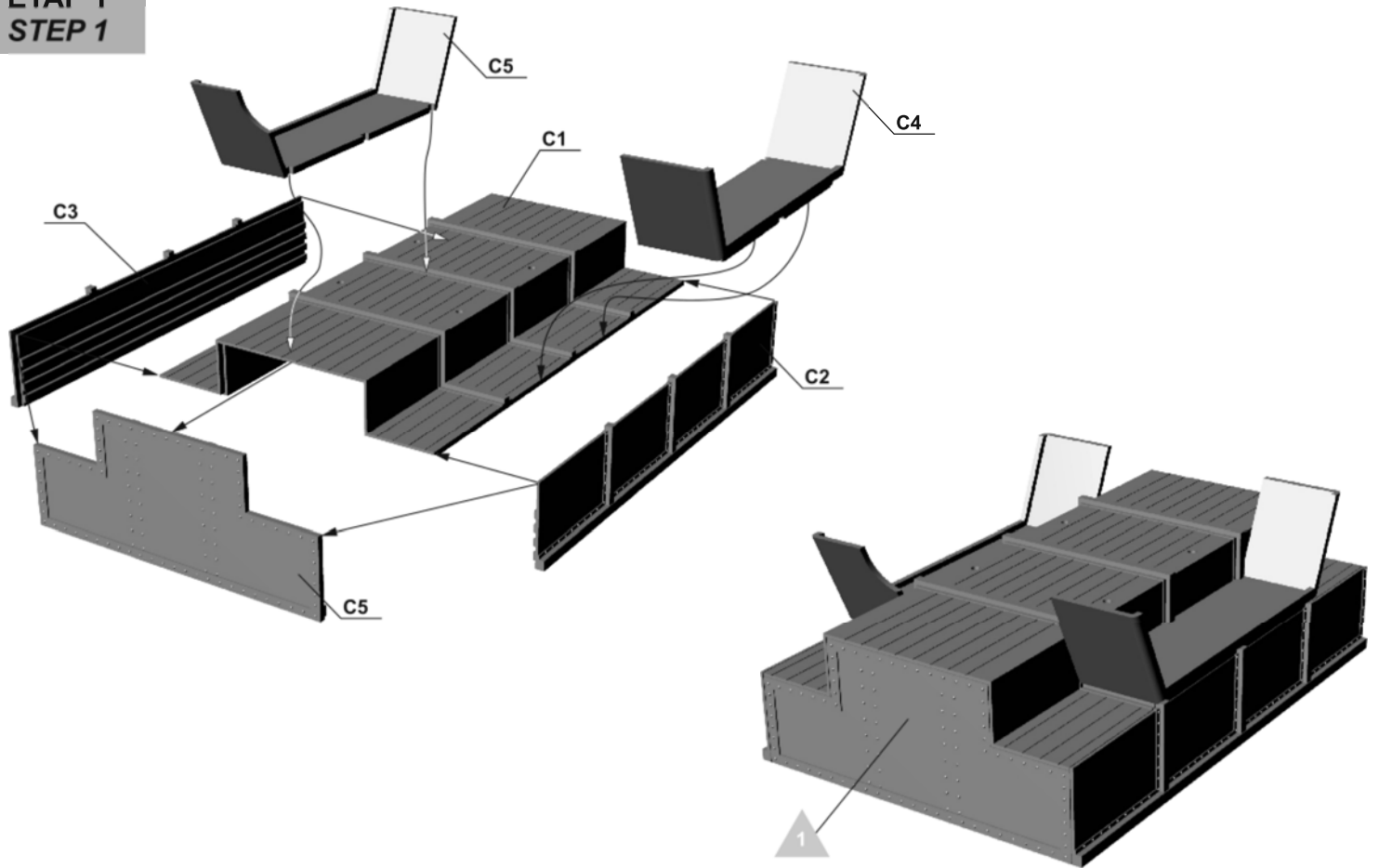

**ETAP 2**  
**STEP 2**

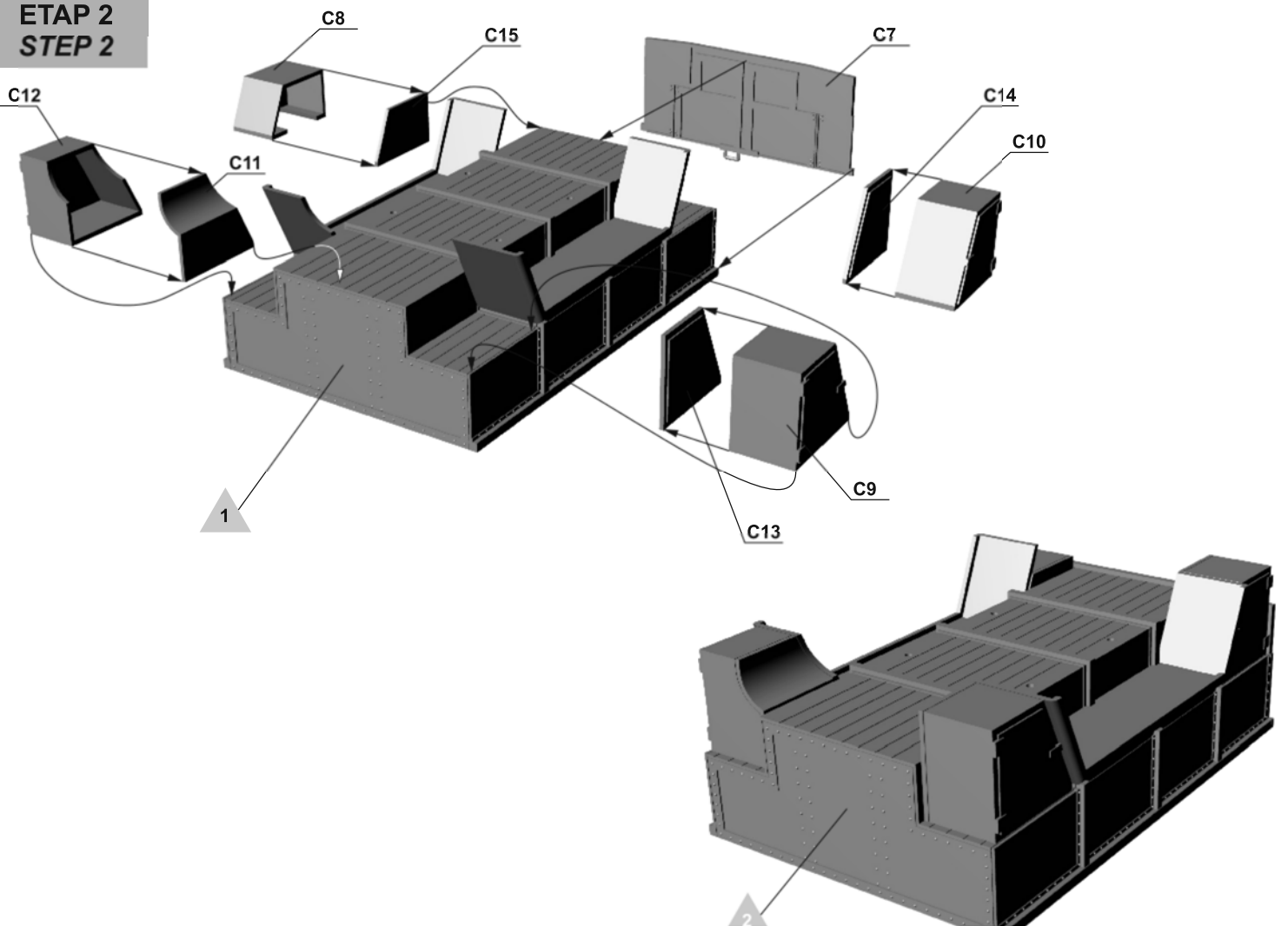

ETAP 3  
STEP 3

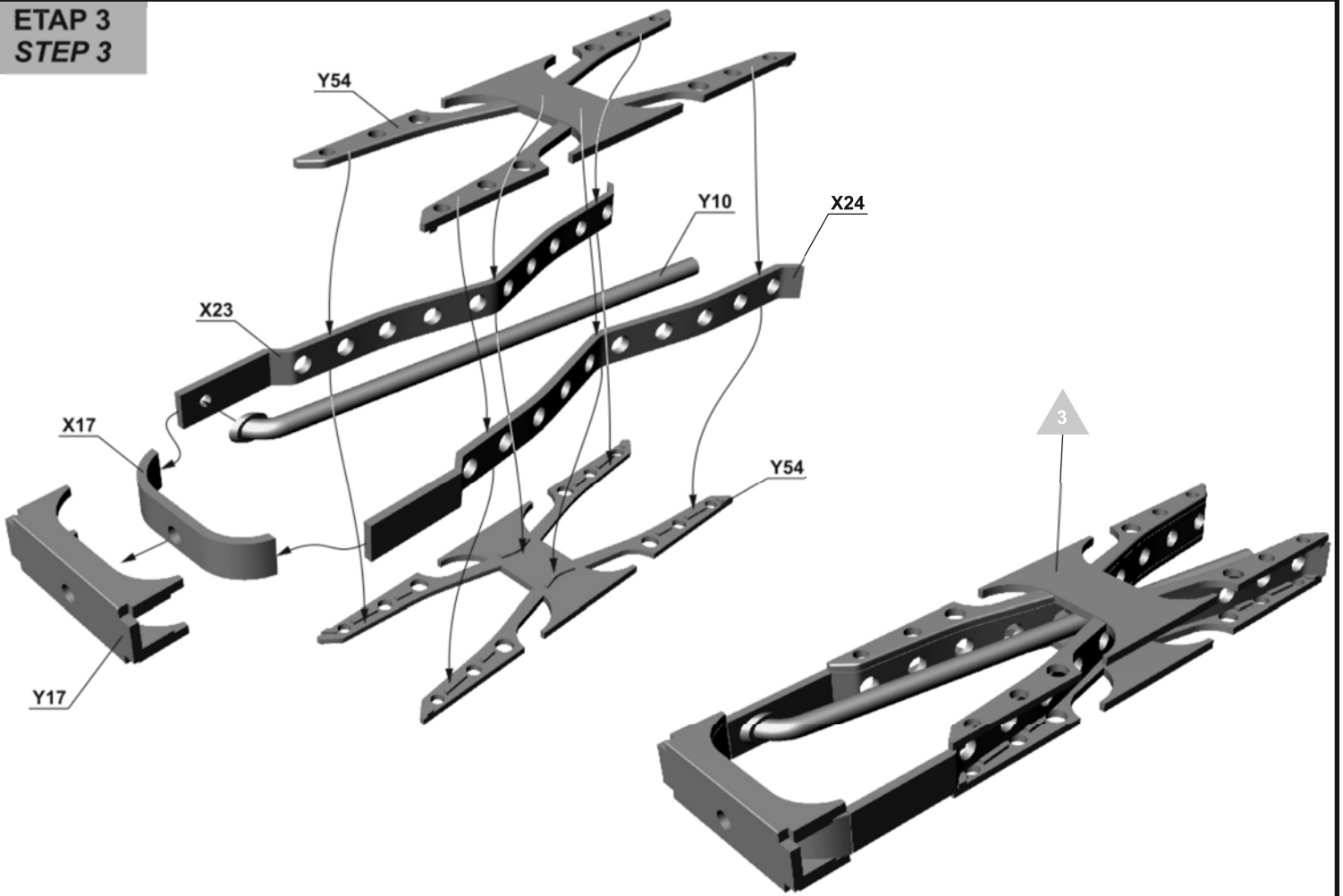

ETAP 4  
STEP 4

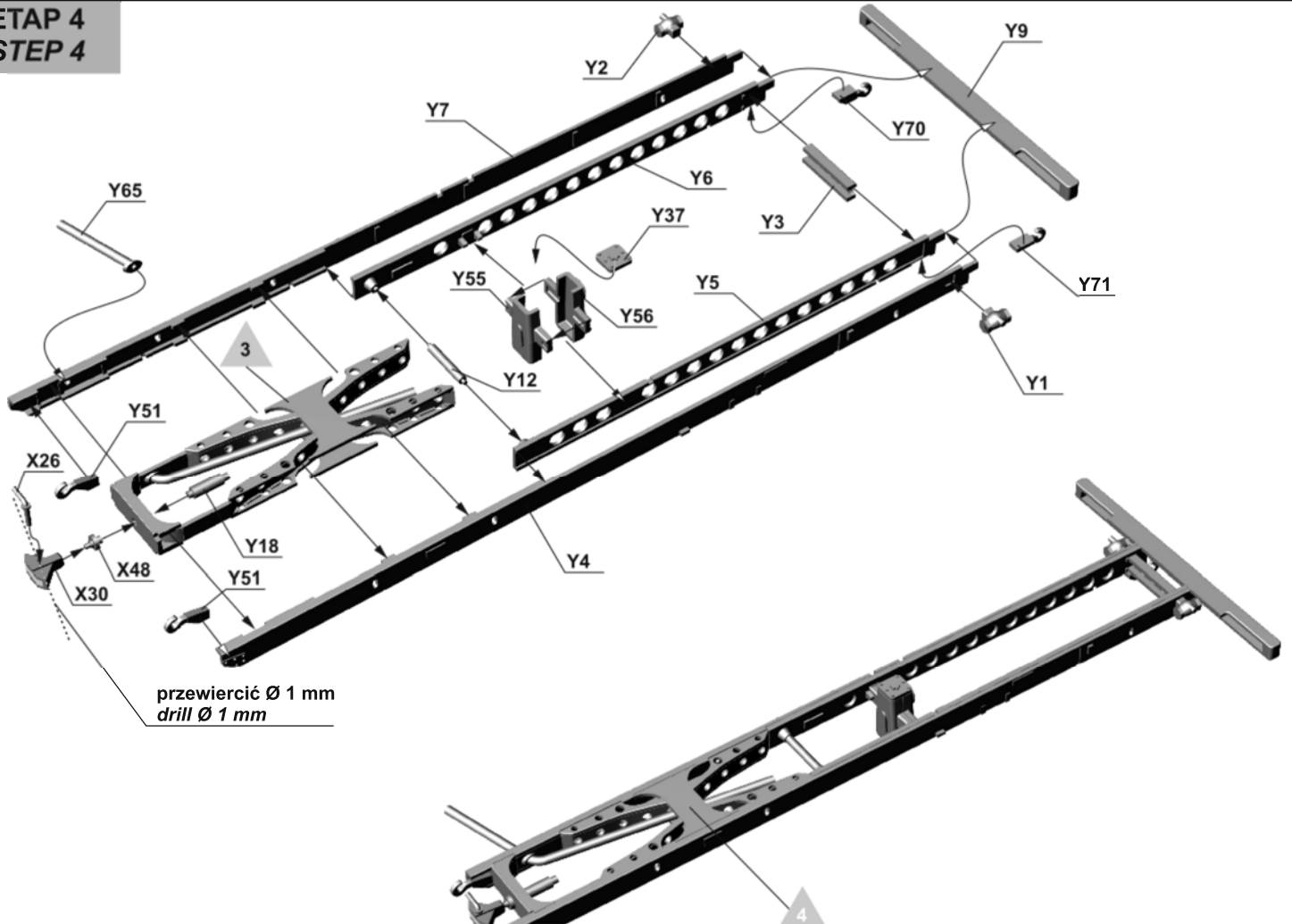

**ETAP 5  
STEP 5**

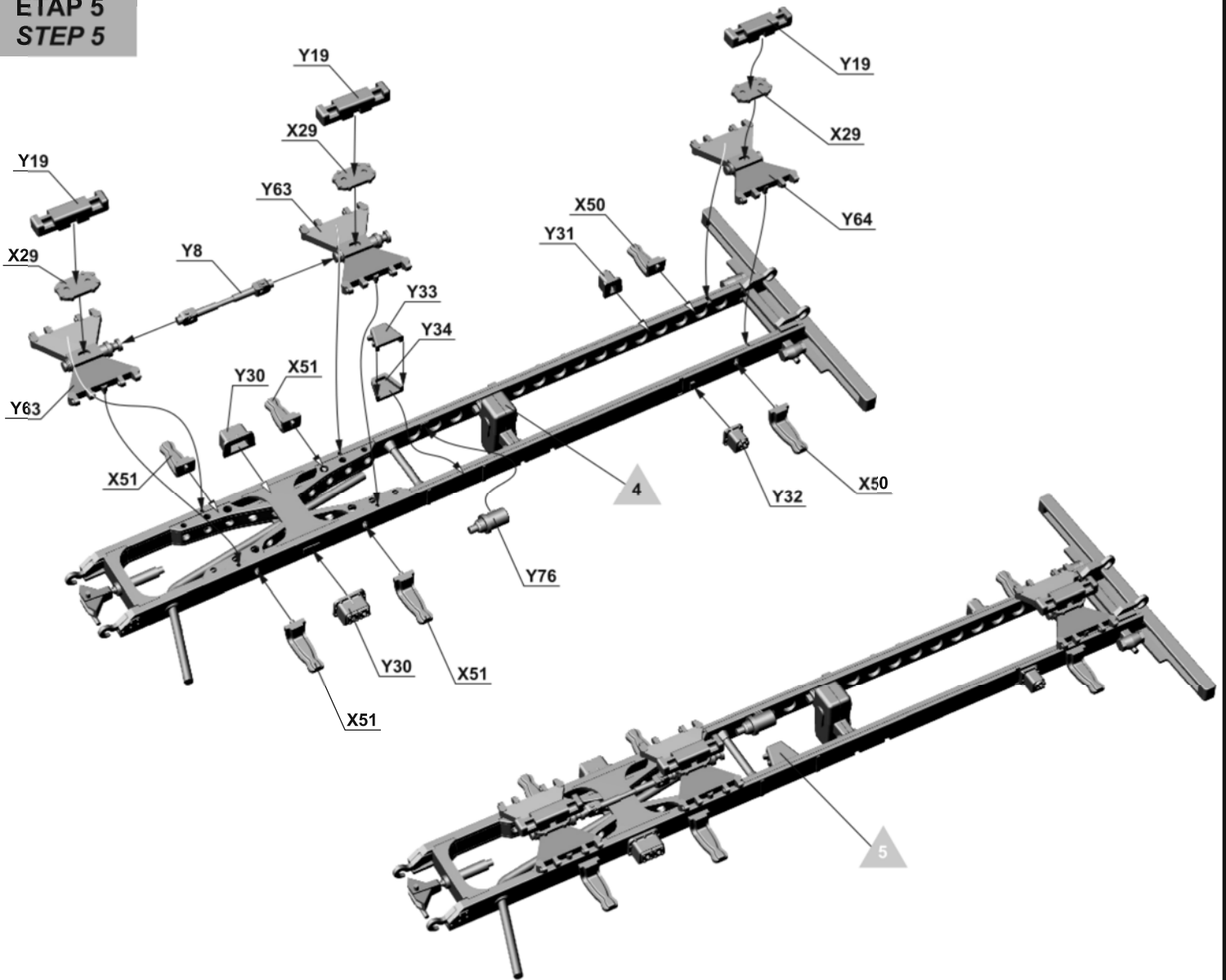

**ETAP 6  
STEP 6**

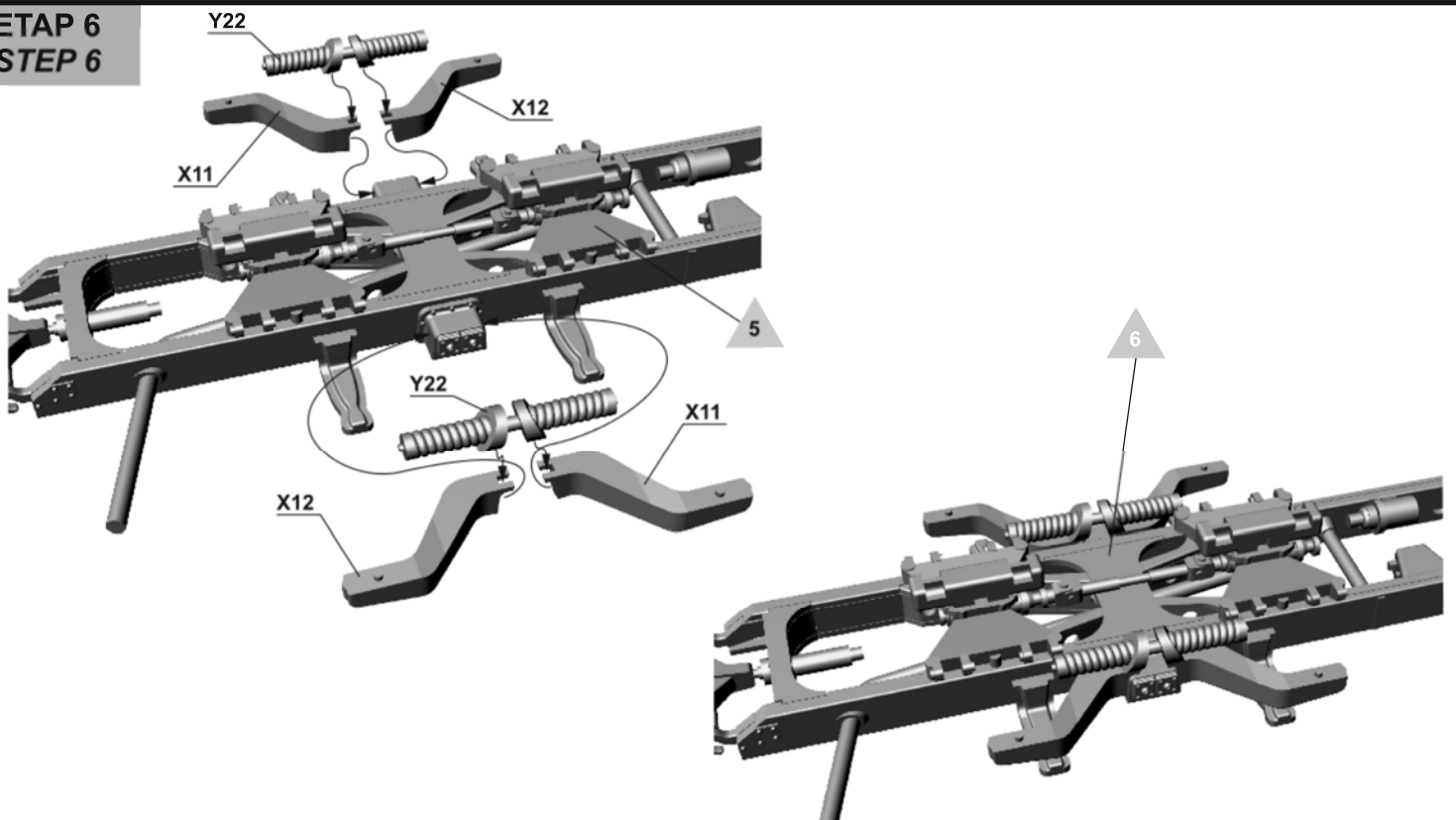

ETAP 7  
STEP 7 x 7

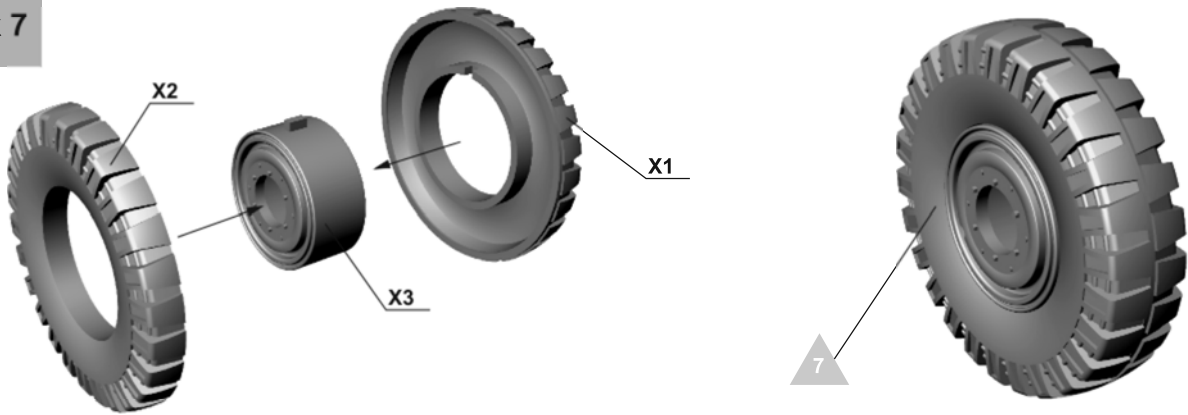

ETAP 8  
STEP 8

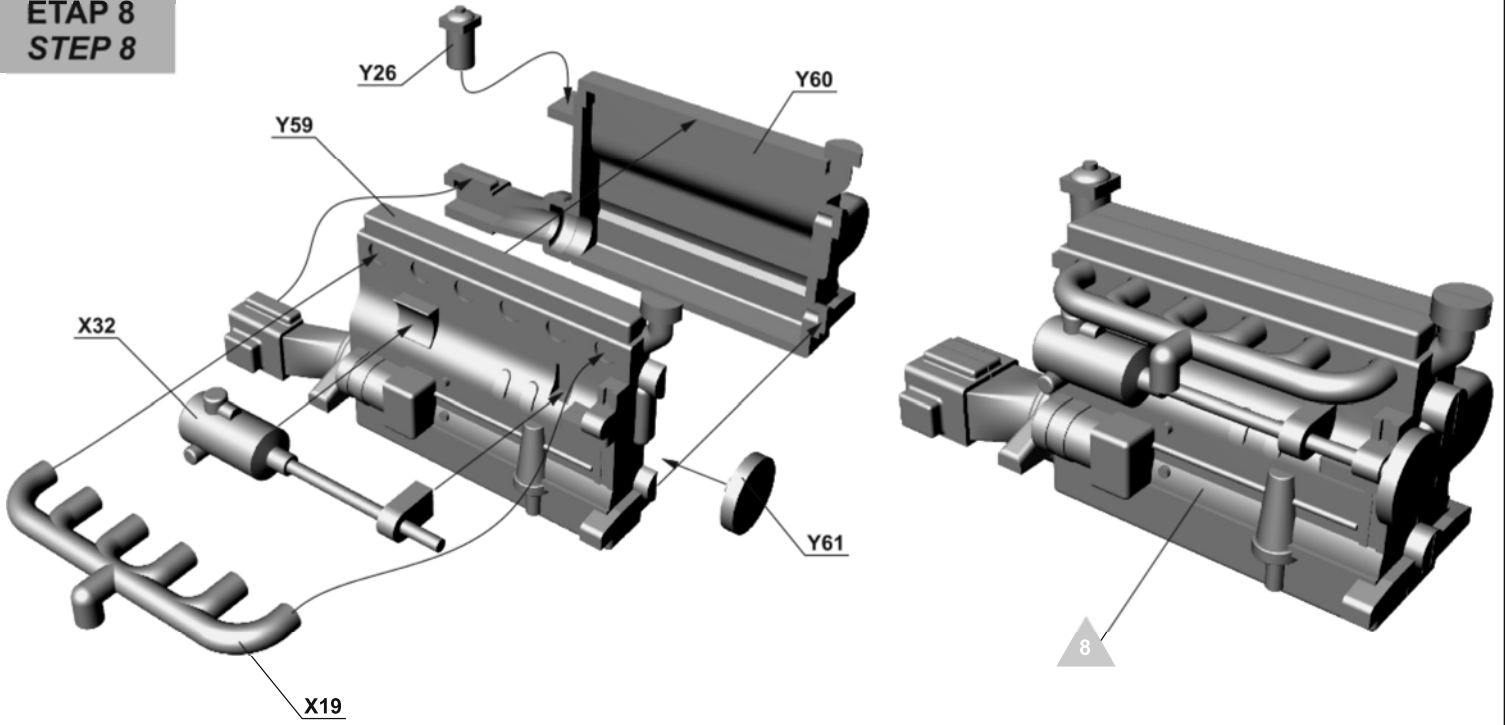

ETAP 9  
STEP 9

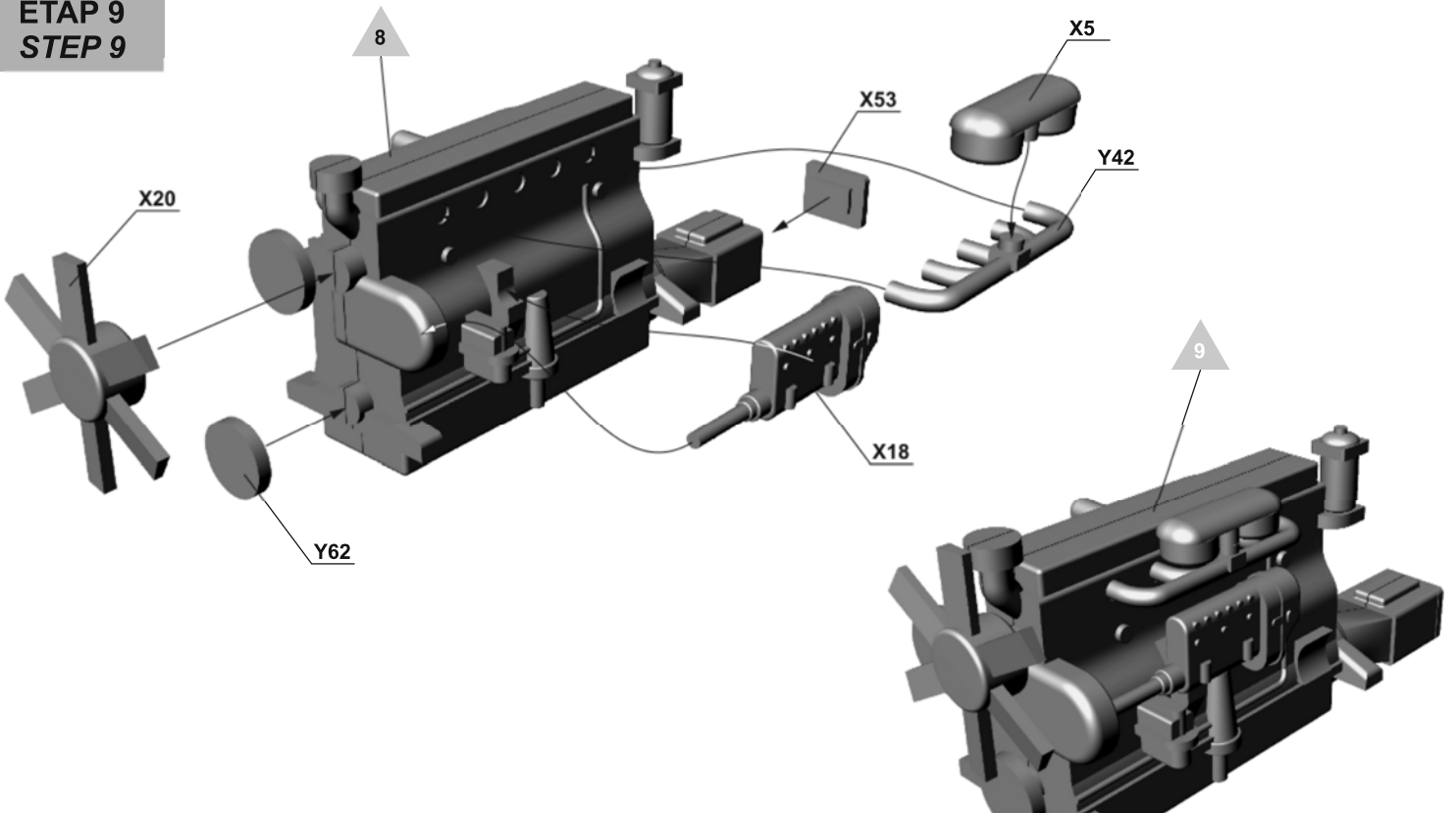

**ETAP 10**  
**STEP 10**

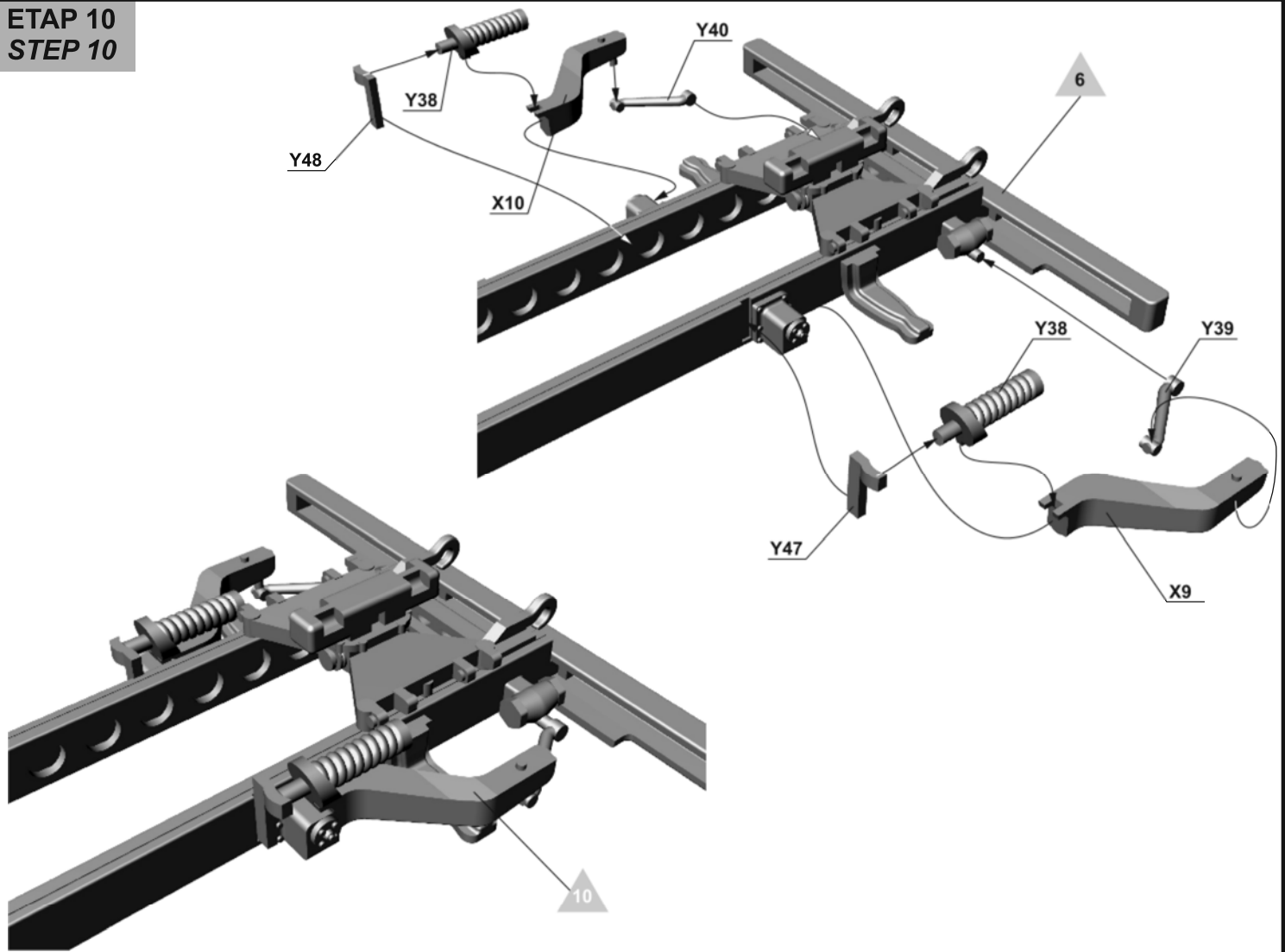

**ETAP 11**  
**STEP 11**

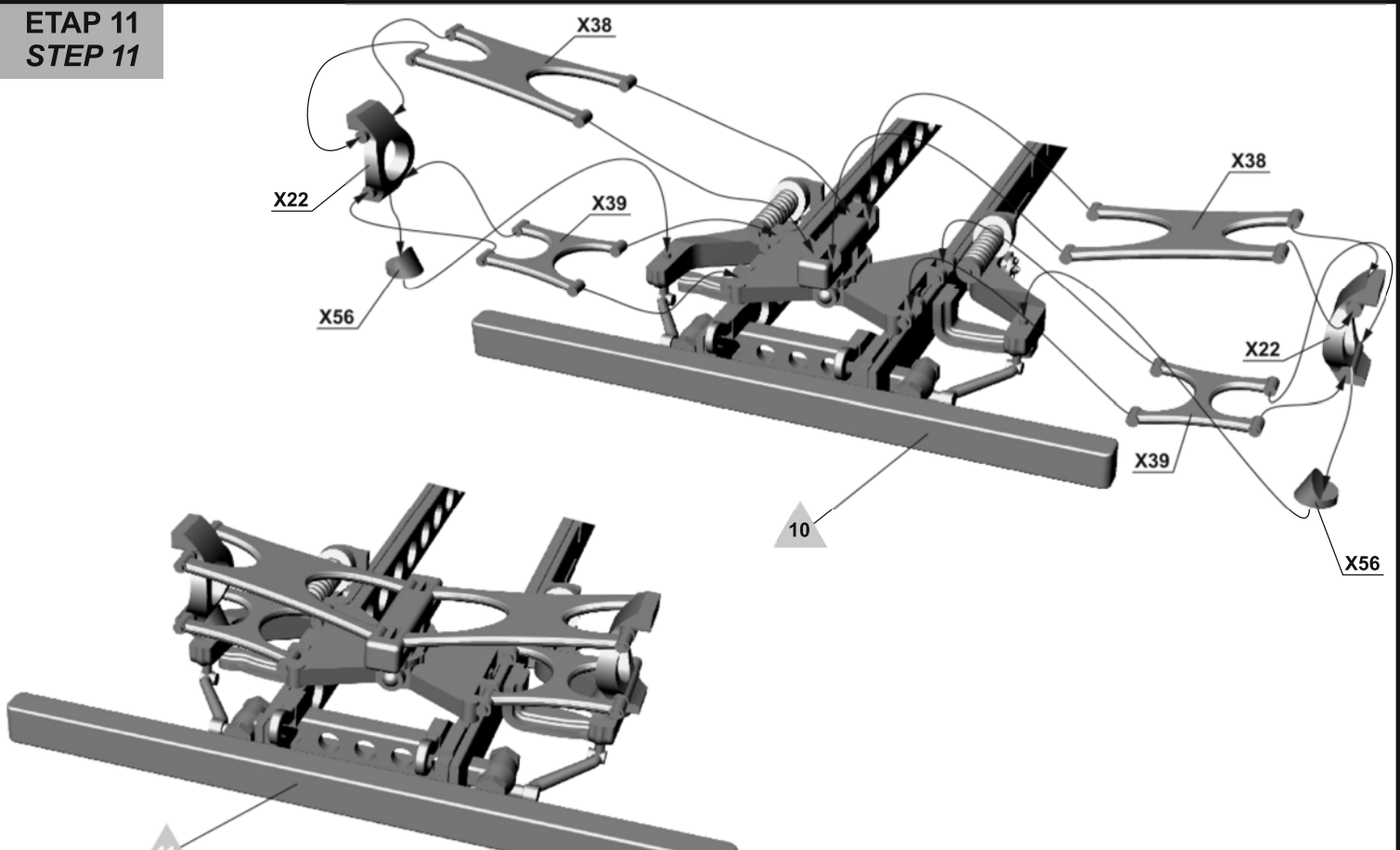

ETAP 12  
STEP 12

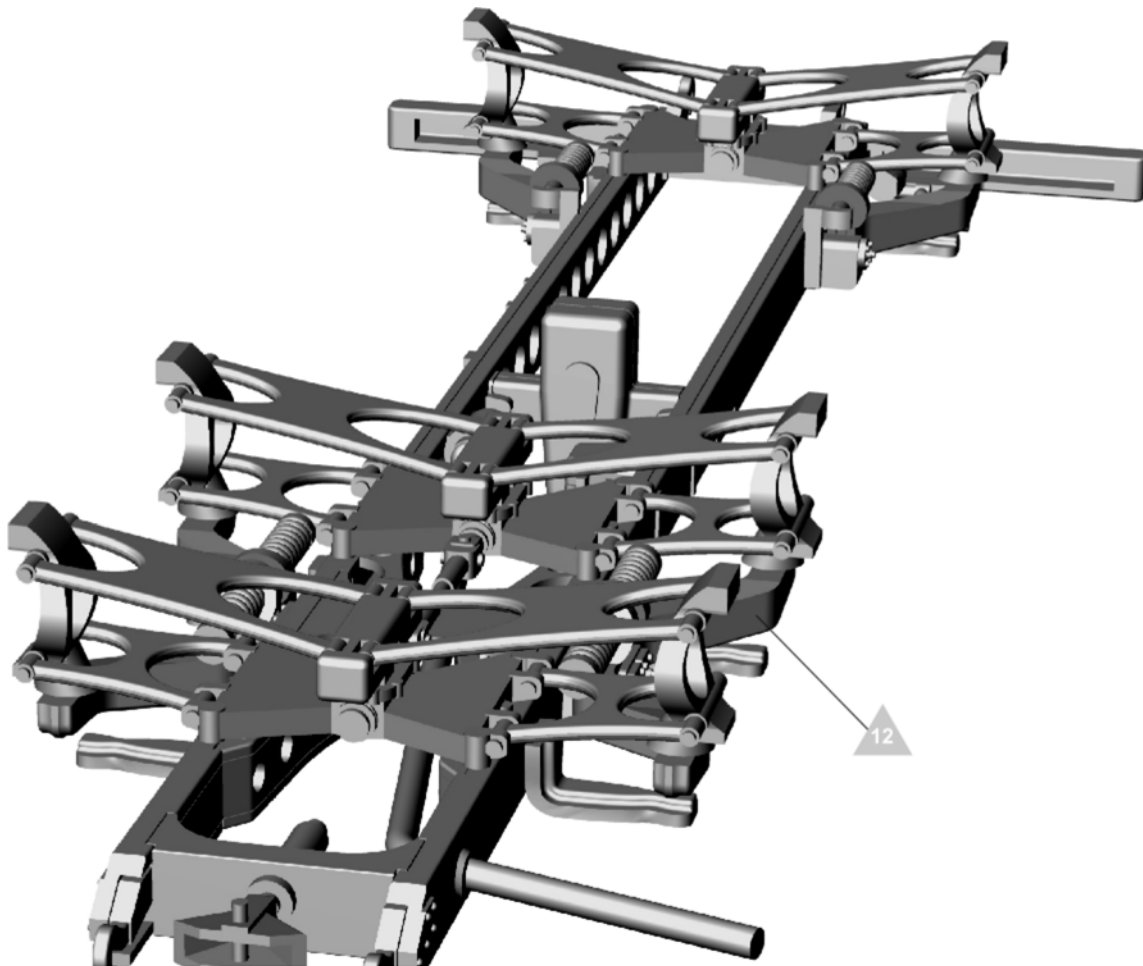
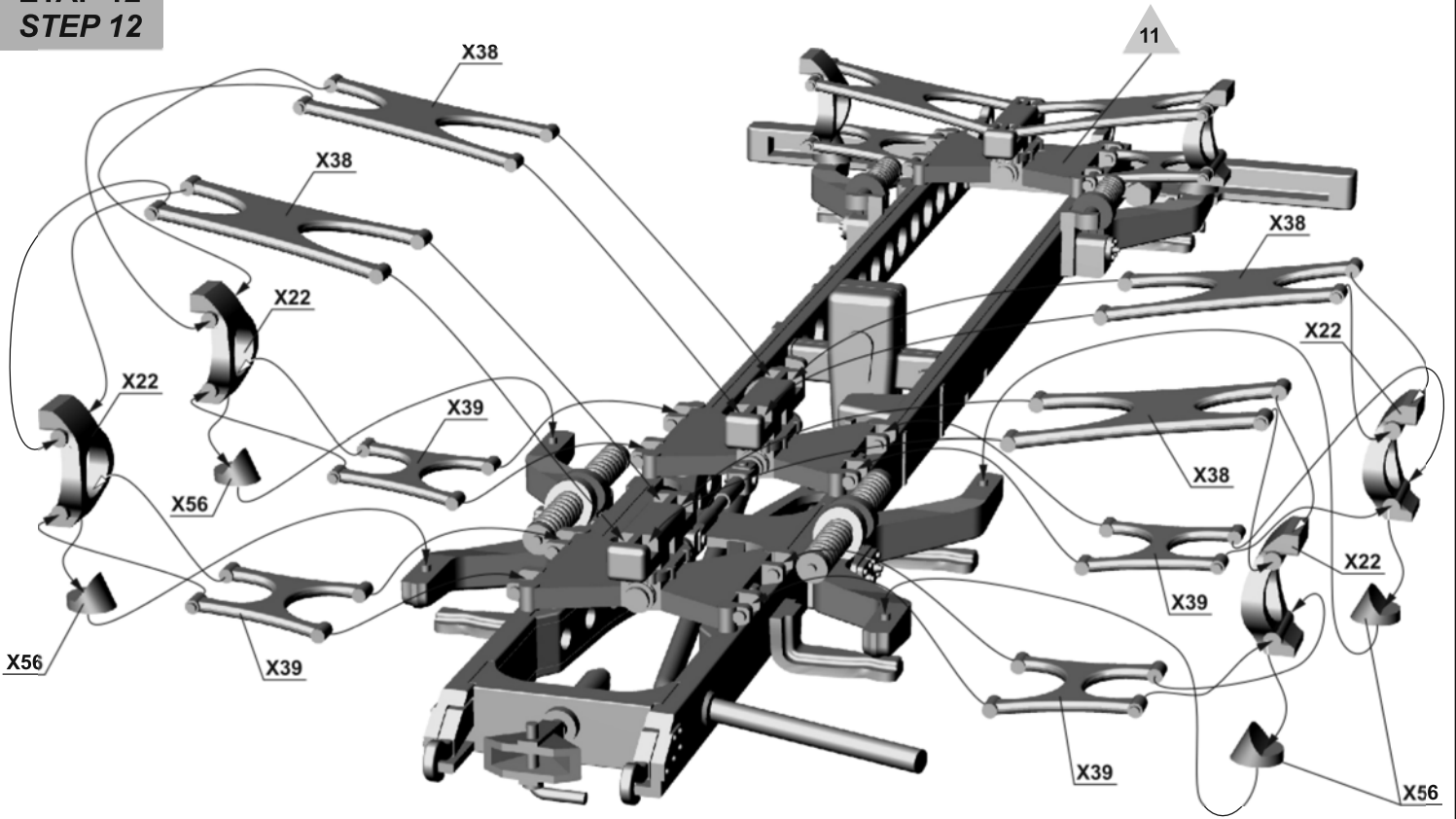

**ETAP 13**  
**STEP 13**

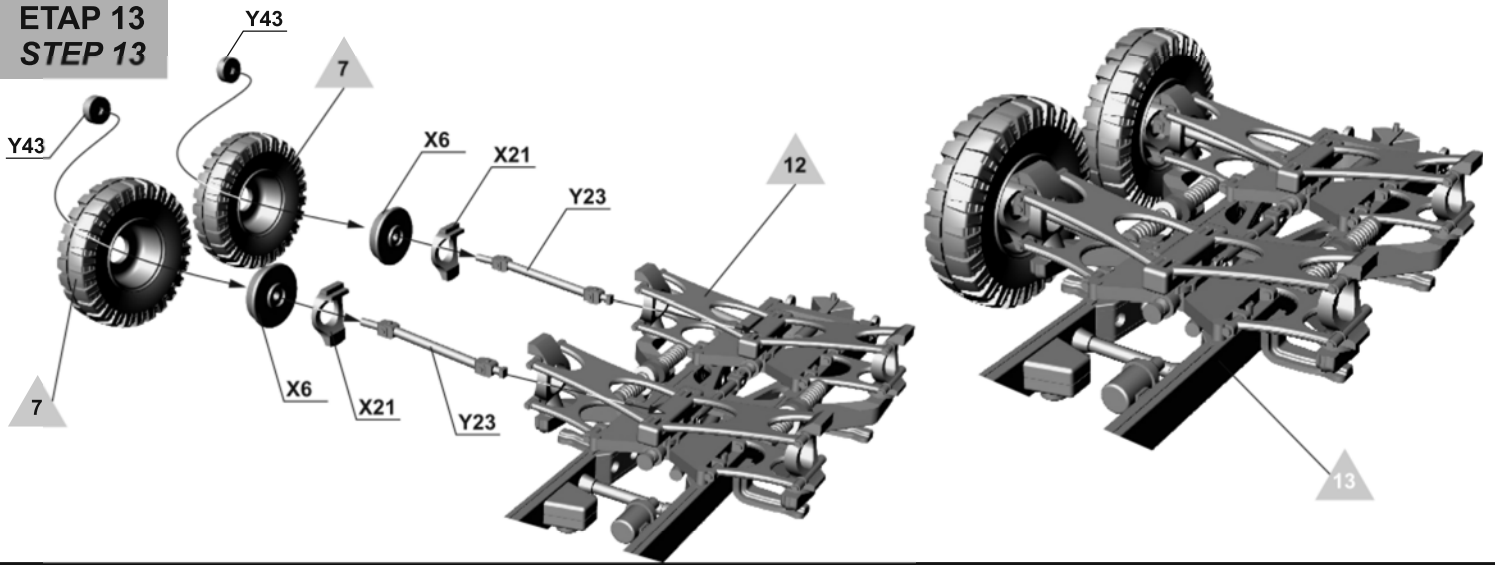

**ETAP 14**  
**STEP 14**

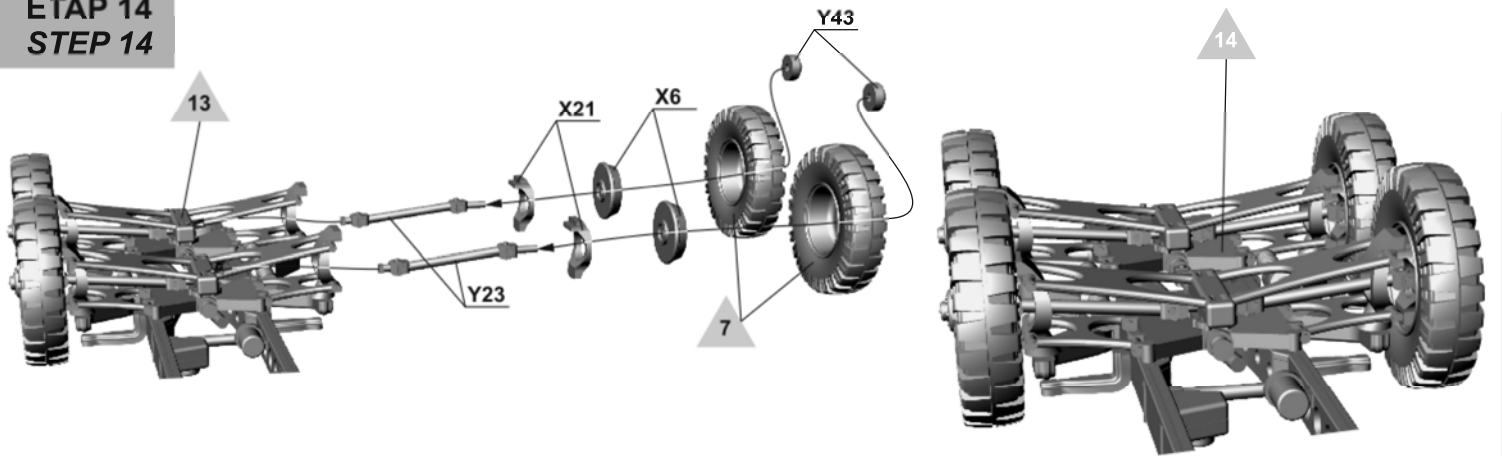

**ETAP 15**  
**STEP 15**

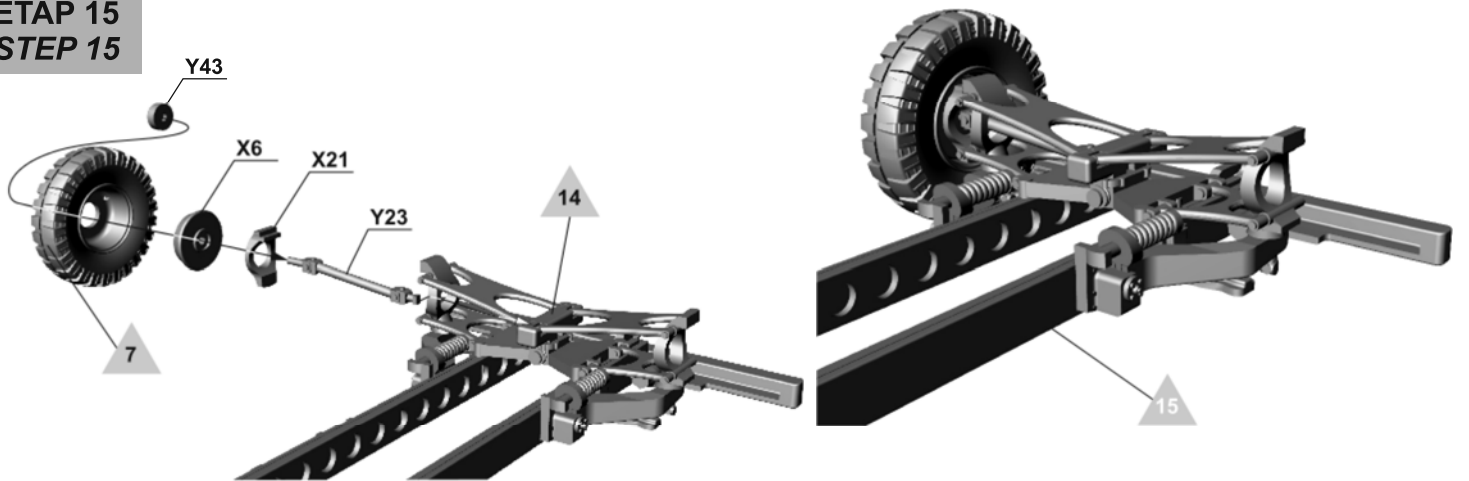

**ETAP 16**  
**STEP 16**

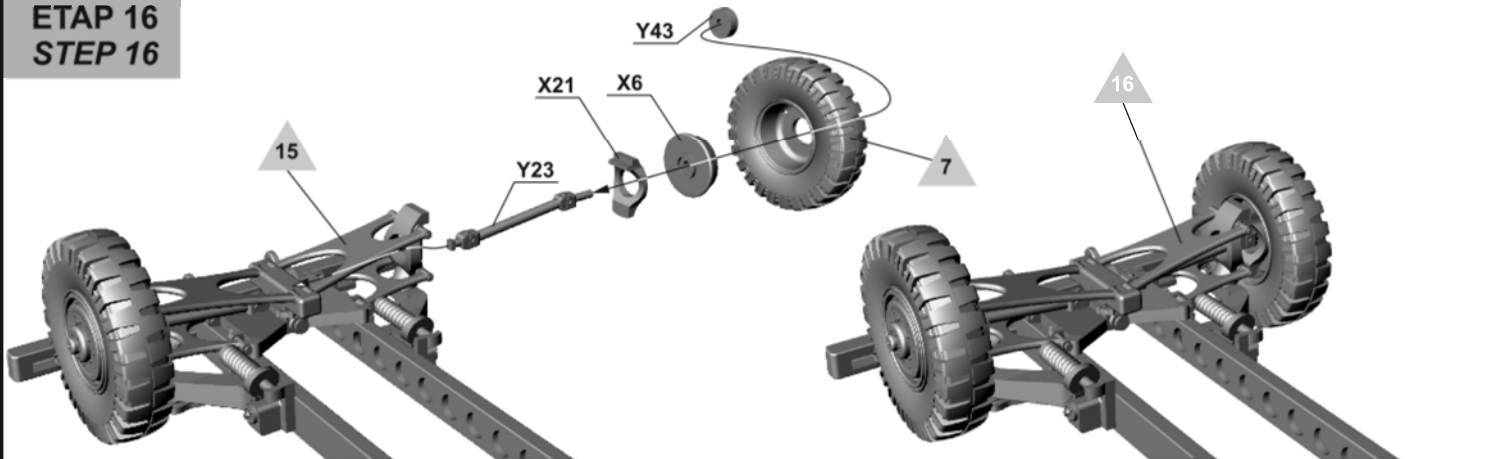

**ETAP 17**  
**STEP 17**

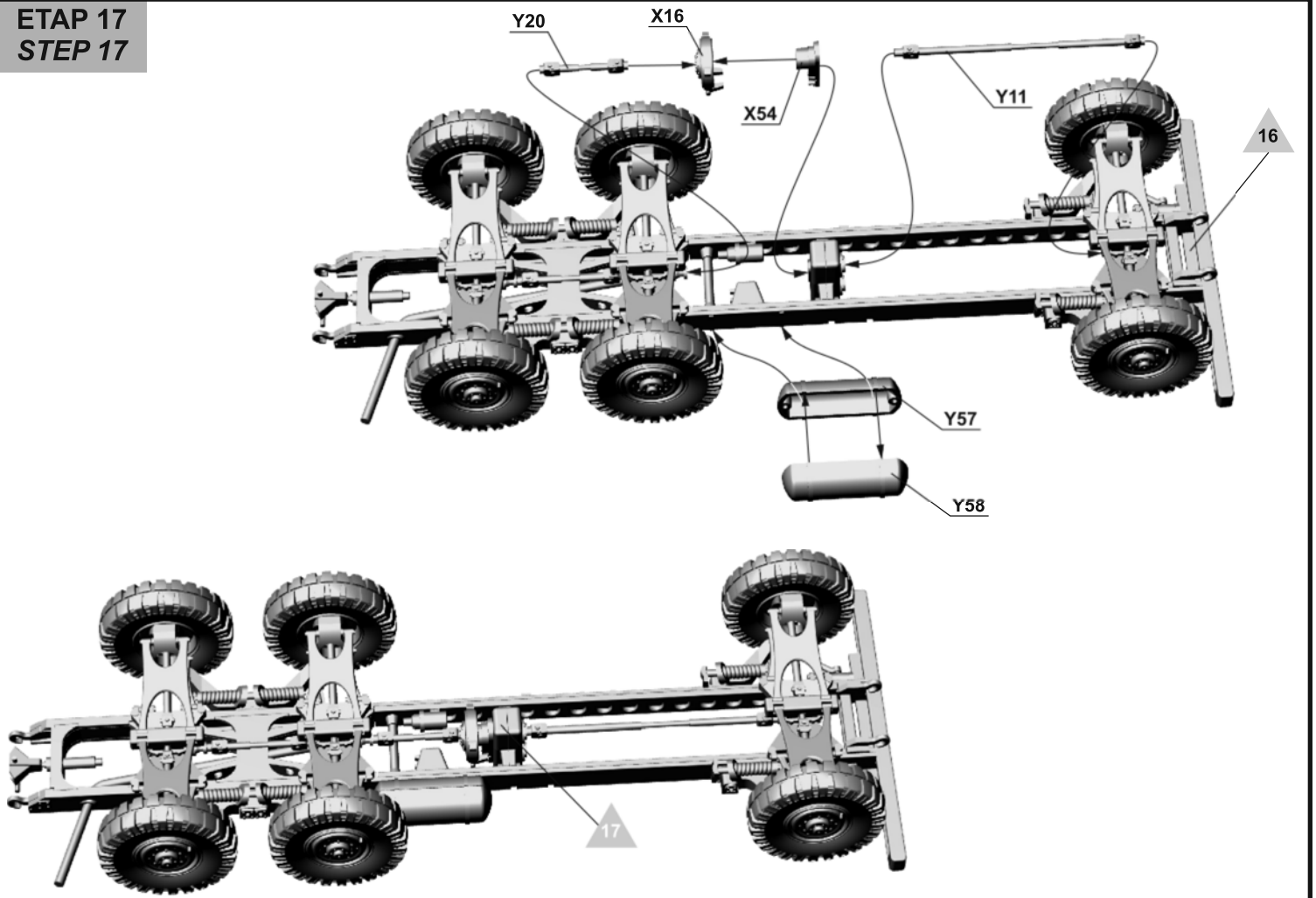

**ETAP 18**  
**STEP 18**

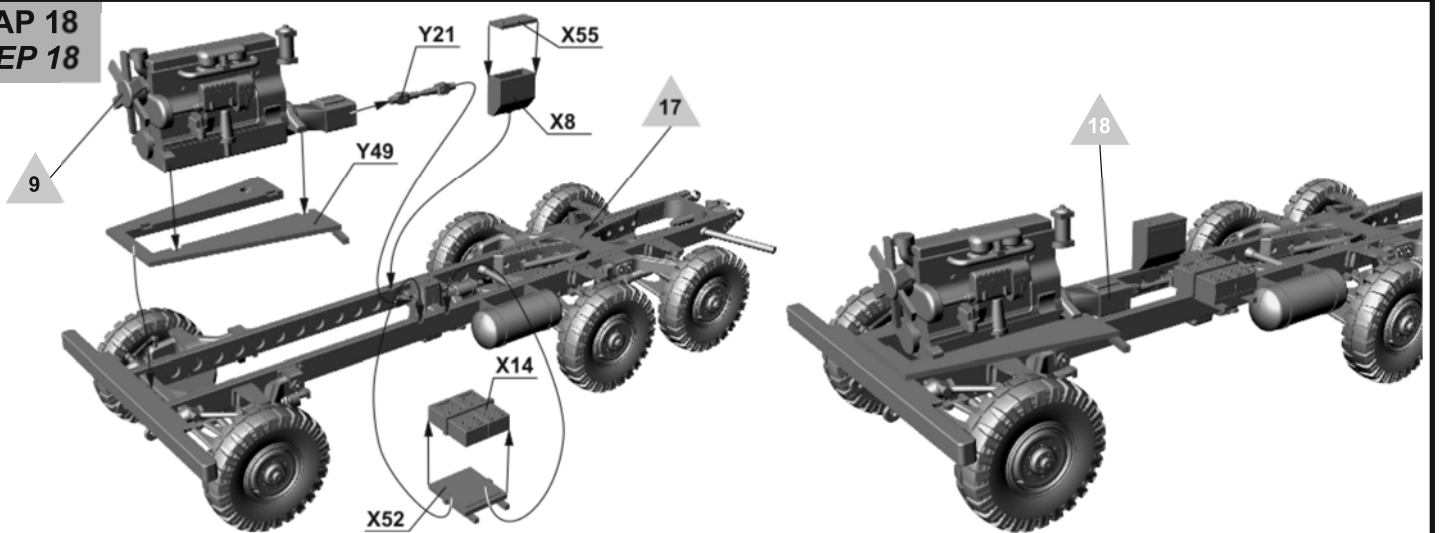

**ETAP 19**  
**STEP 19**

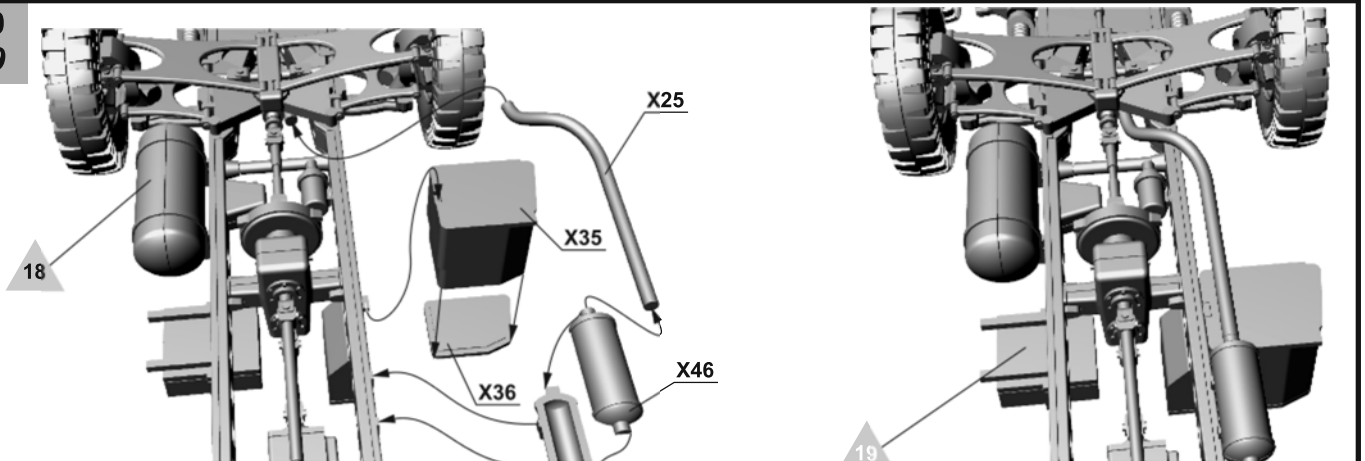

**ETAP 20**  
**STEP 20**

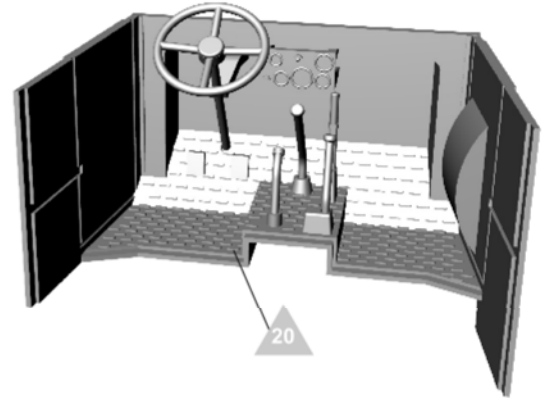
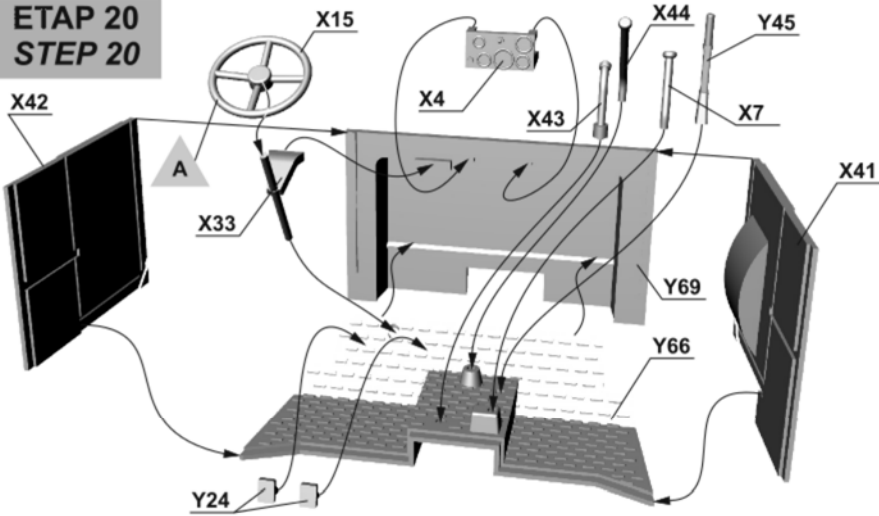

**ETAP 21**  
**STEP 21**

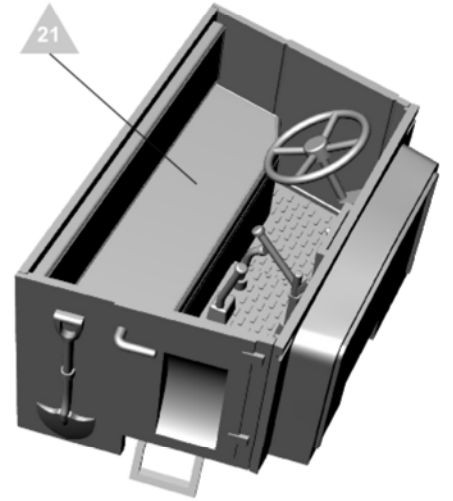
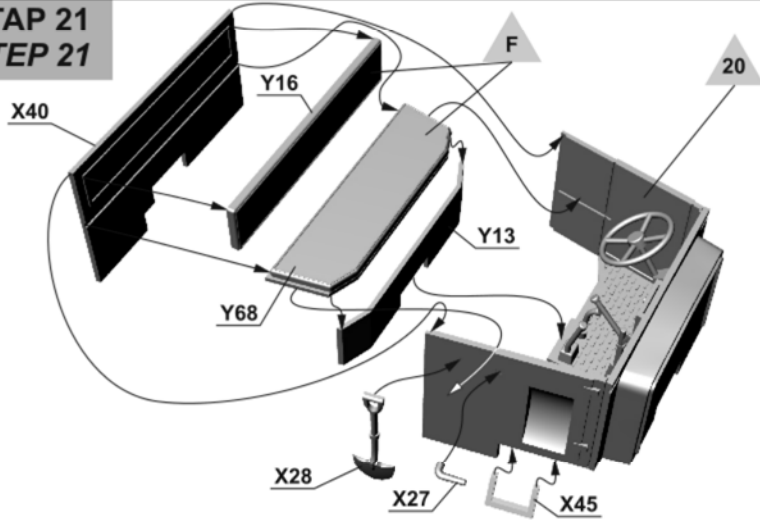

**ETAP 22**  
**STEP 22**

Przezroczysta 1  
Clear 1

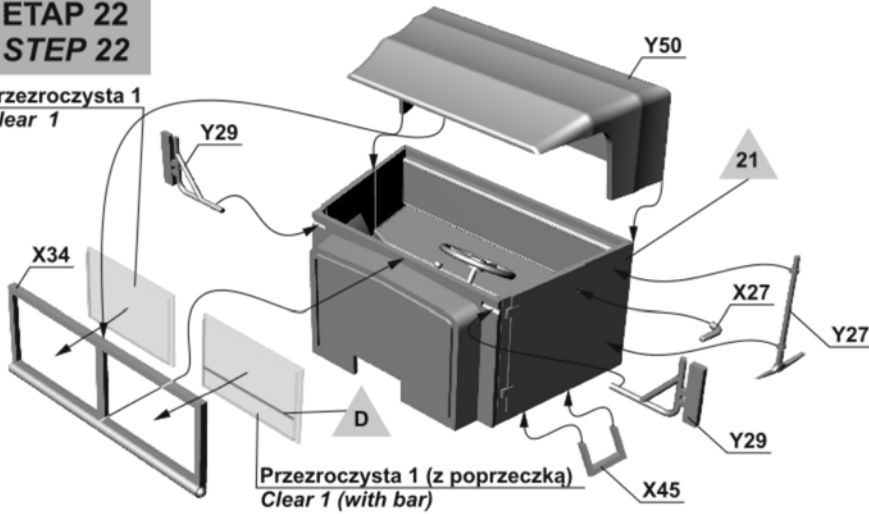

Przezroczysta 1 (z poprzeczką)  
Clear 1 (with bar)

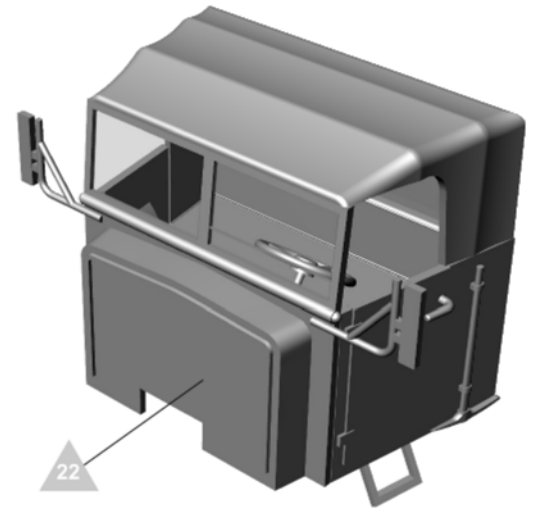

**ETAP 23**  
**STEP 23**

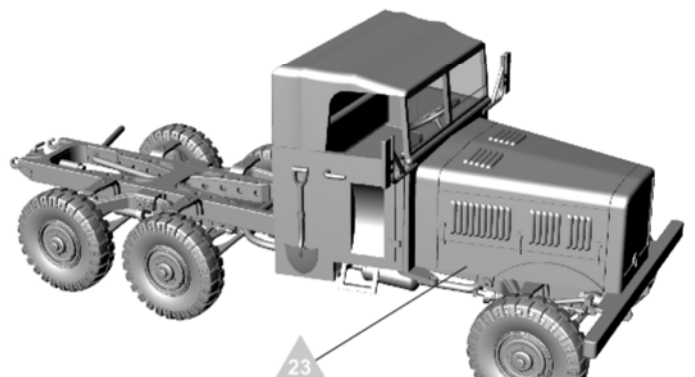
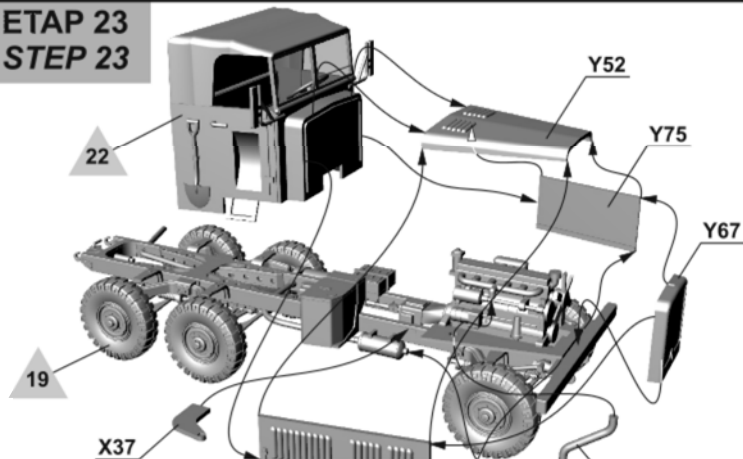

**ETAP 24**  
**STEP 24**

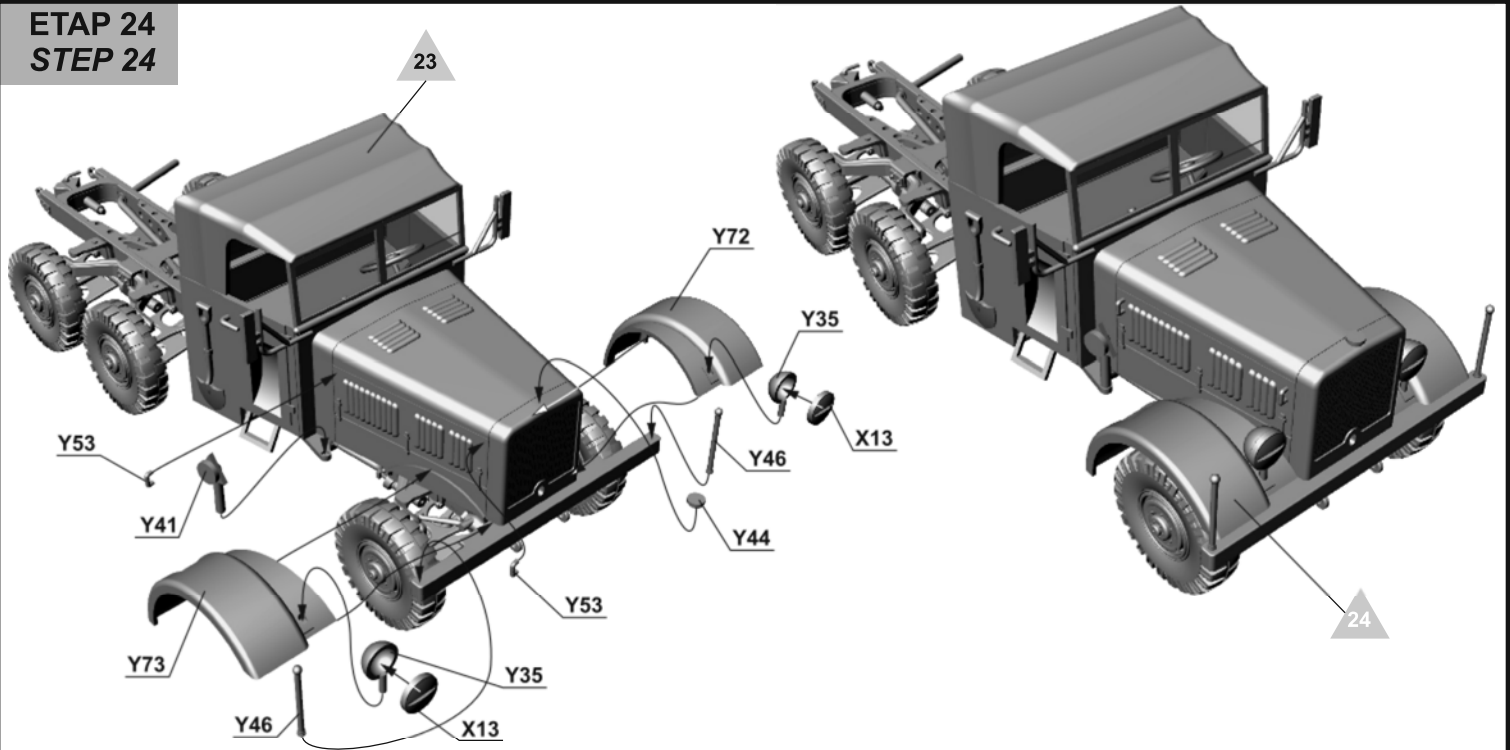

**ETAP 25**  
**STEP 25**

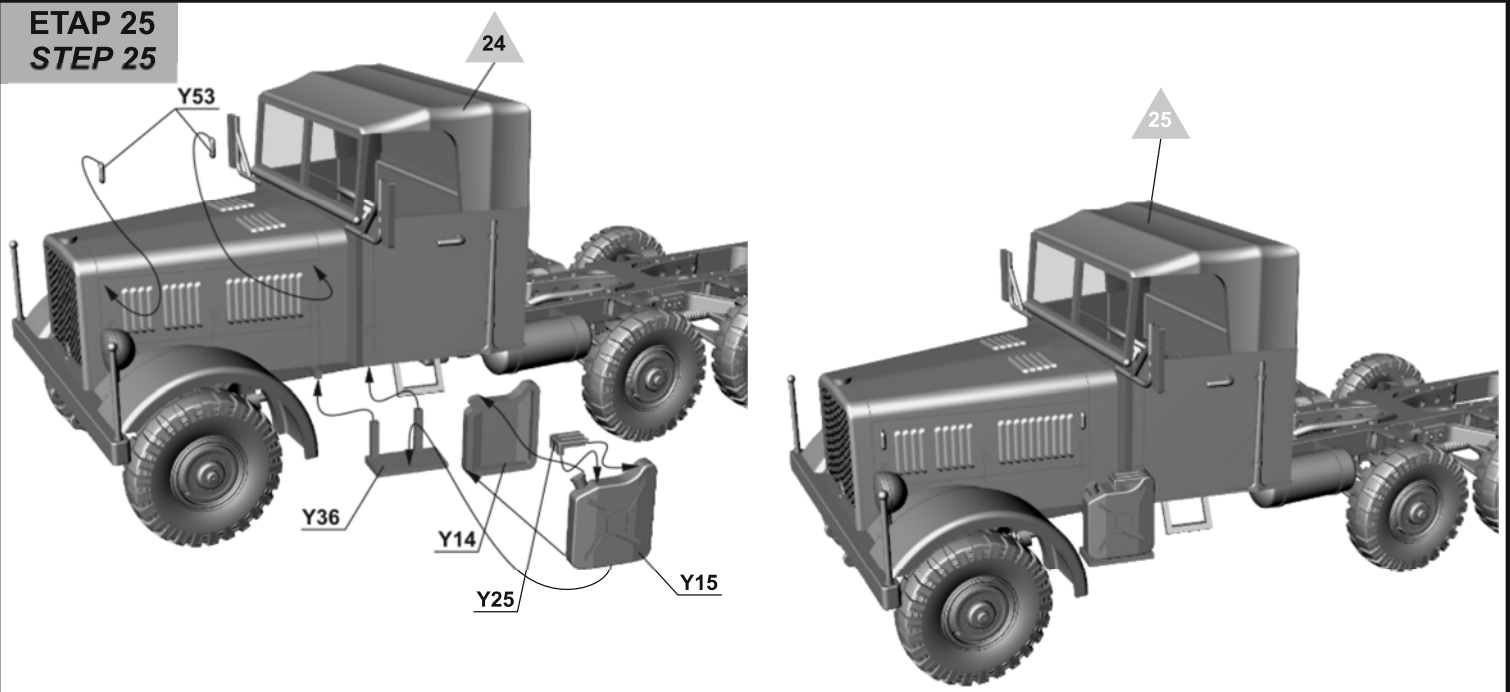

**ETAP 26**  
**STEP 26**

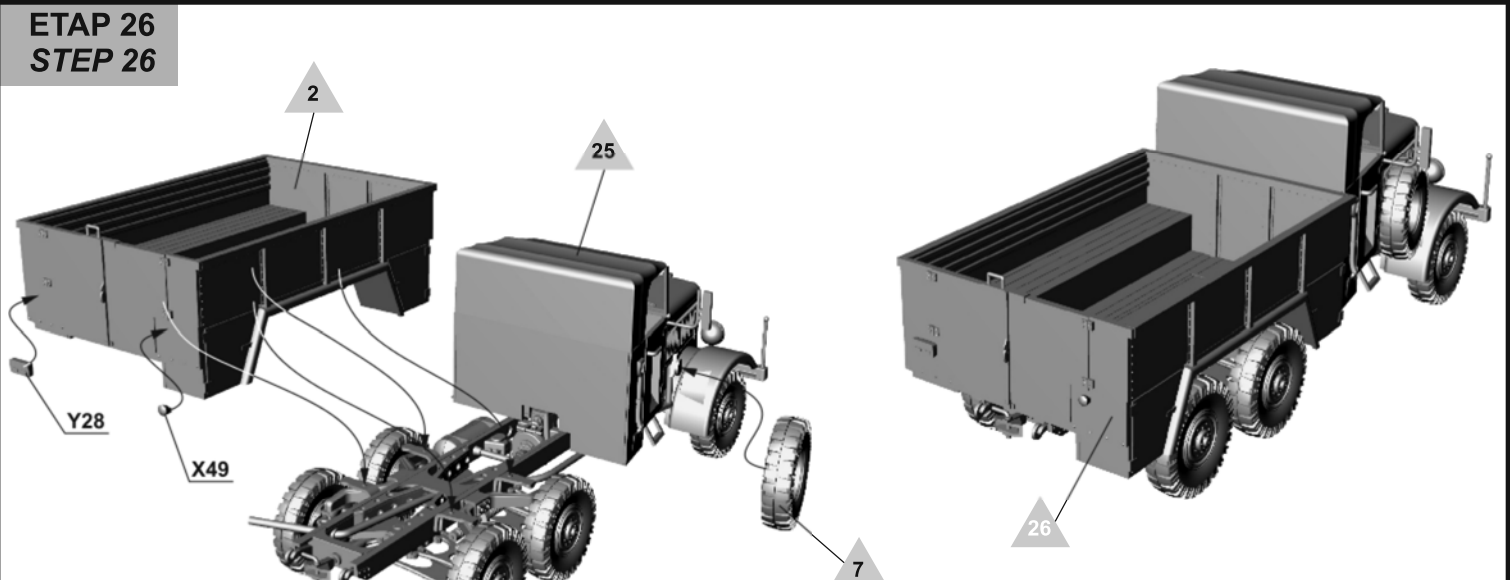

**ETAP 27**  
**STEP 27**

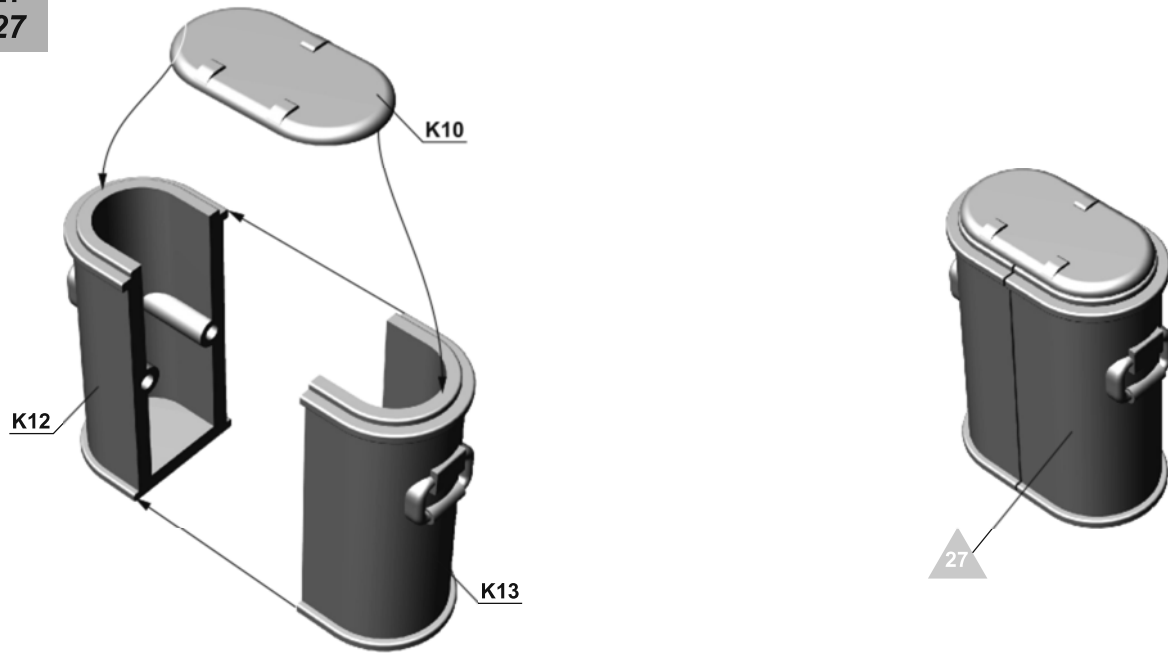

**ETAP 28**  
**STEP 28**

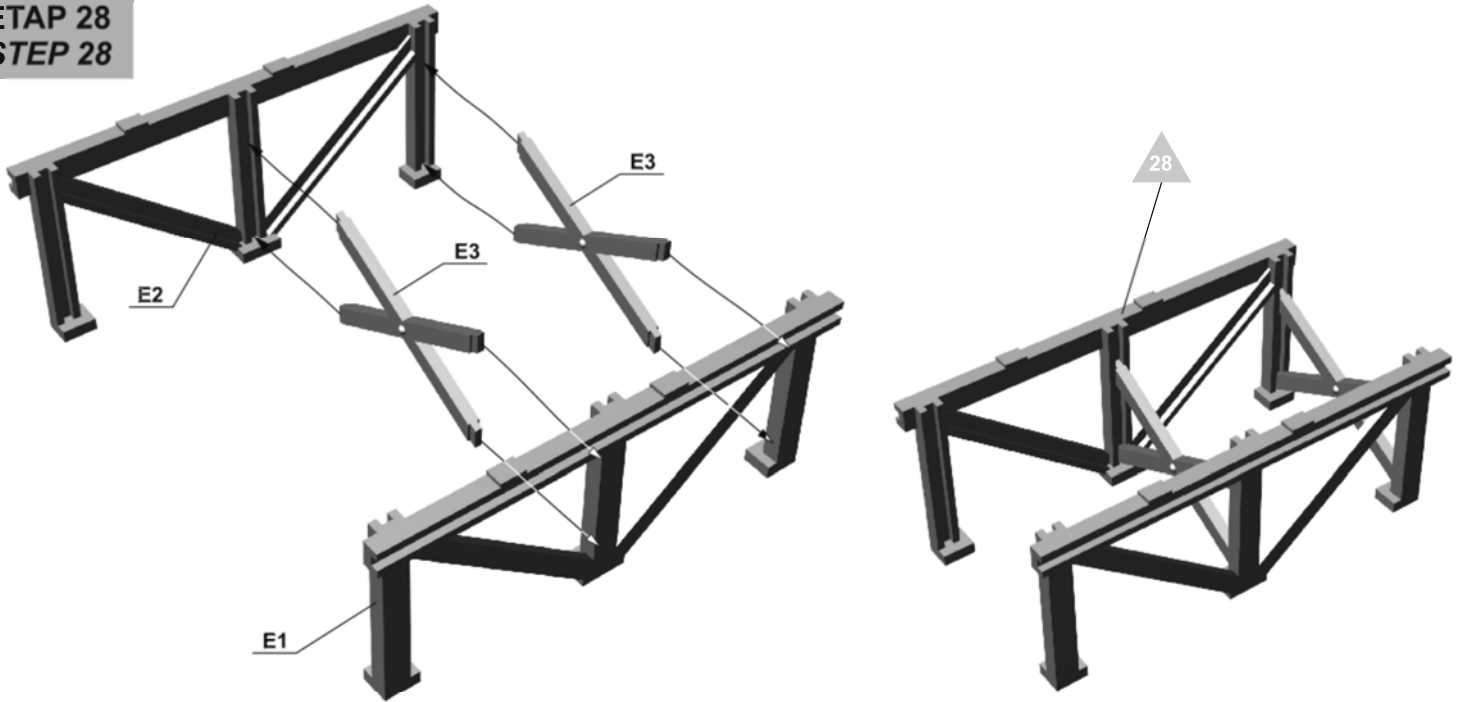

**ETAP 29**  
**STEP 29**

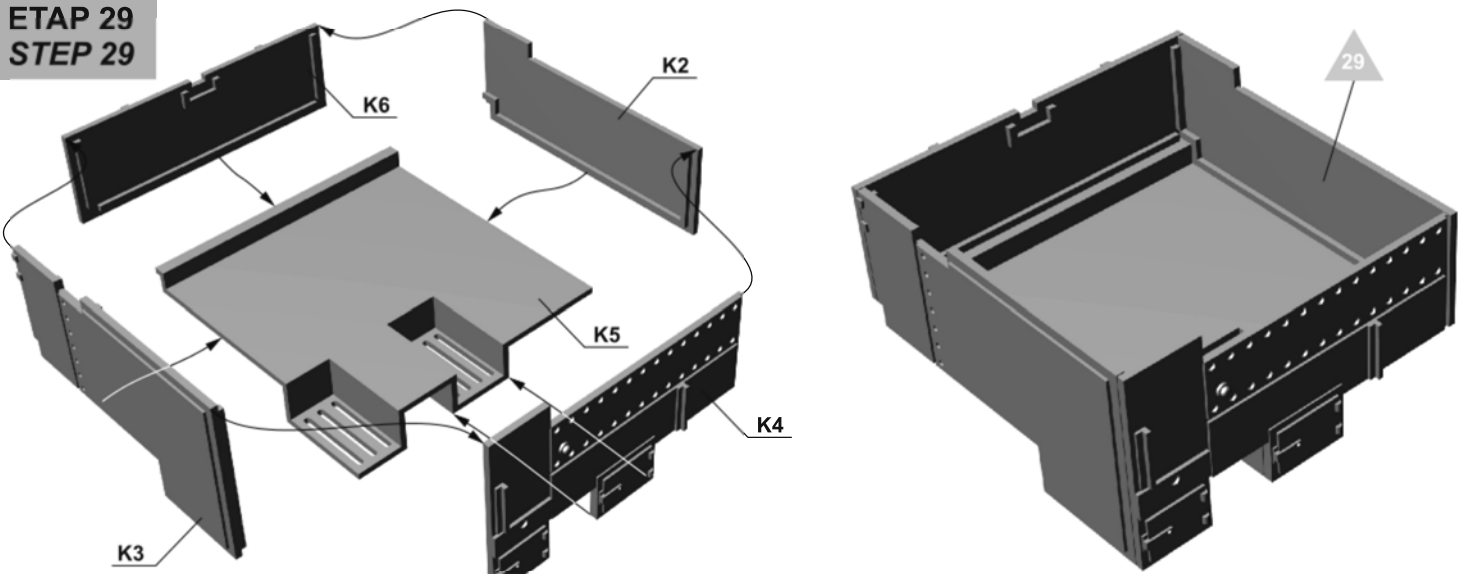

**ETAP 30**  
**STEP 30**

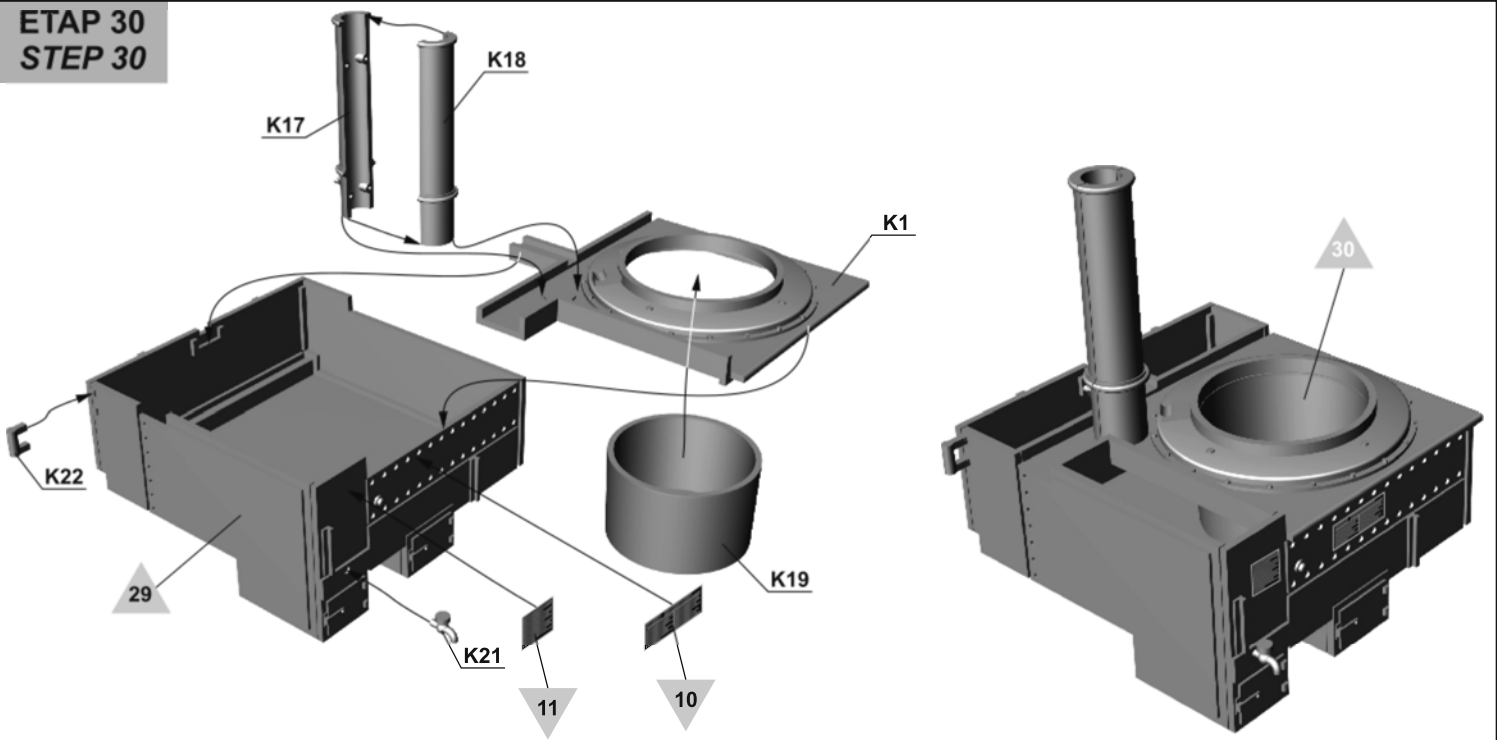

**ETAP 31**  
**STEP 31**

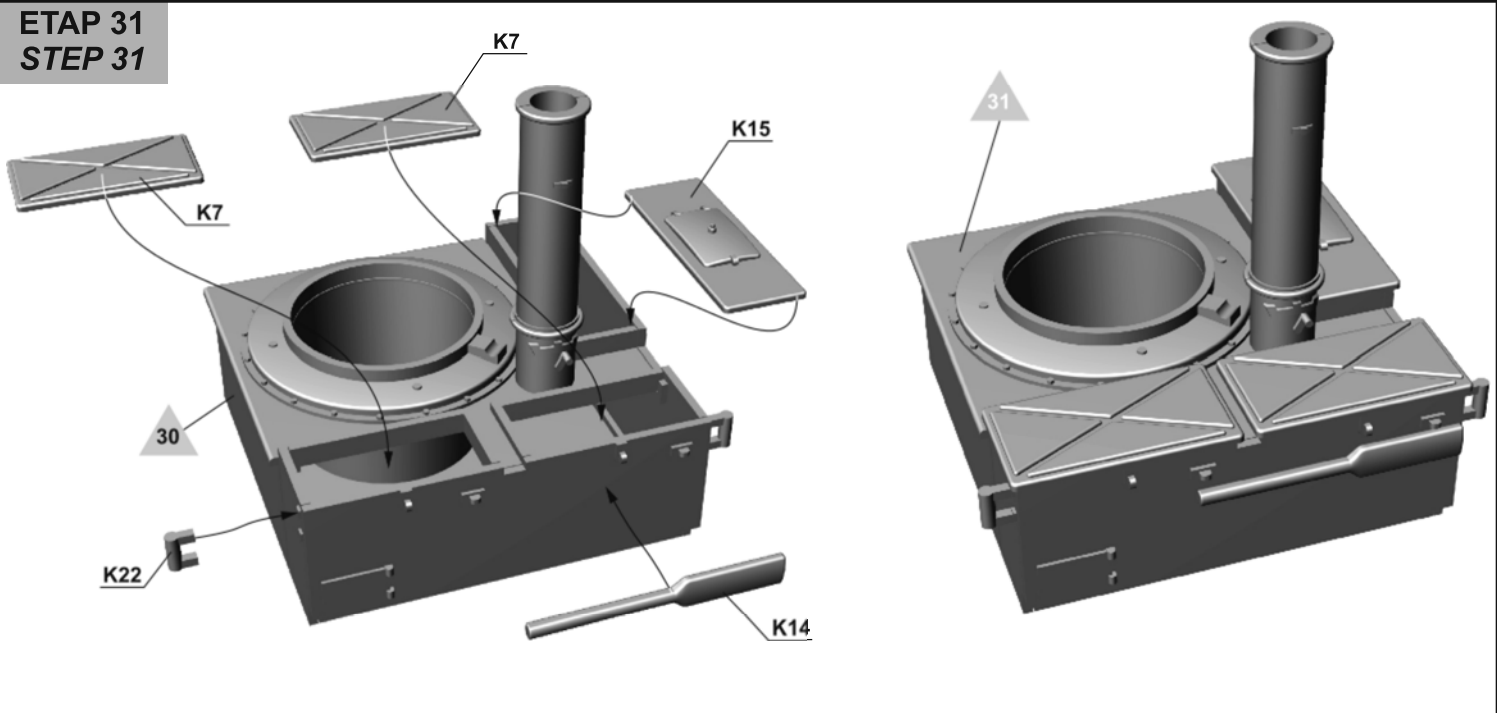

**ETAP 32**  
**STEP 32**

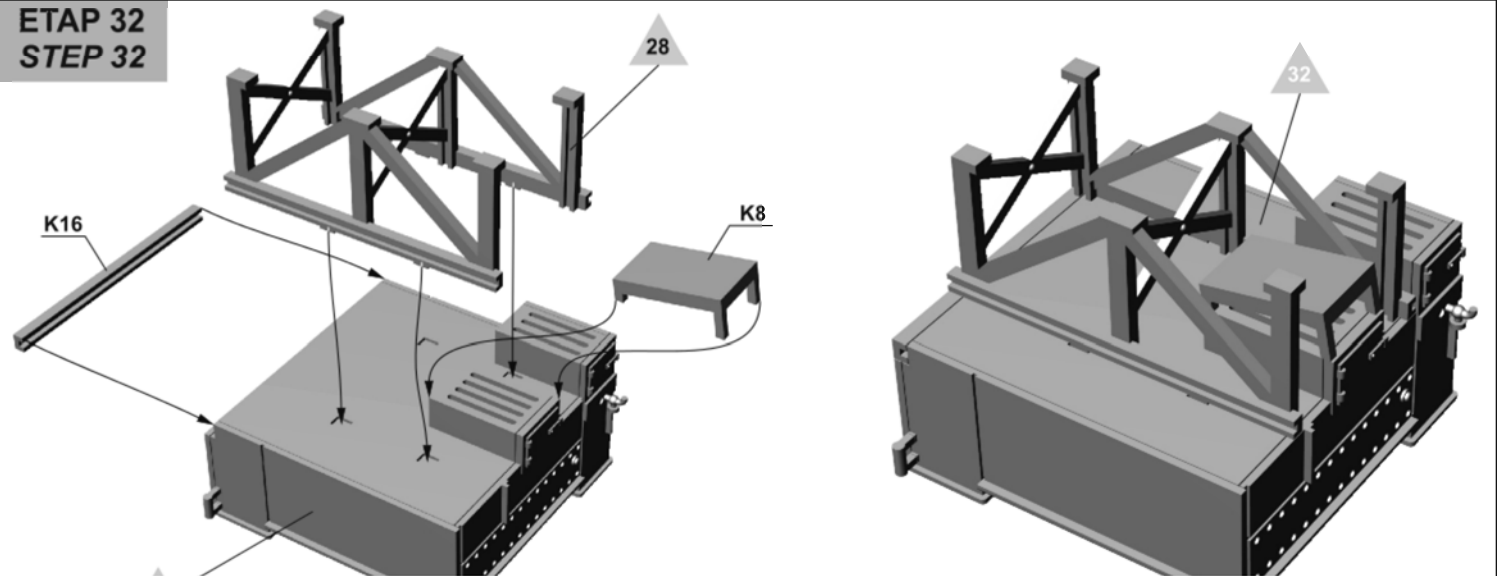

**ETAP 33**  
**STEP 33**

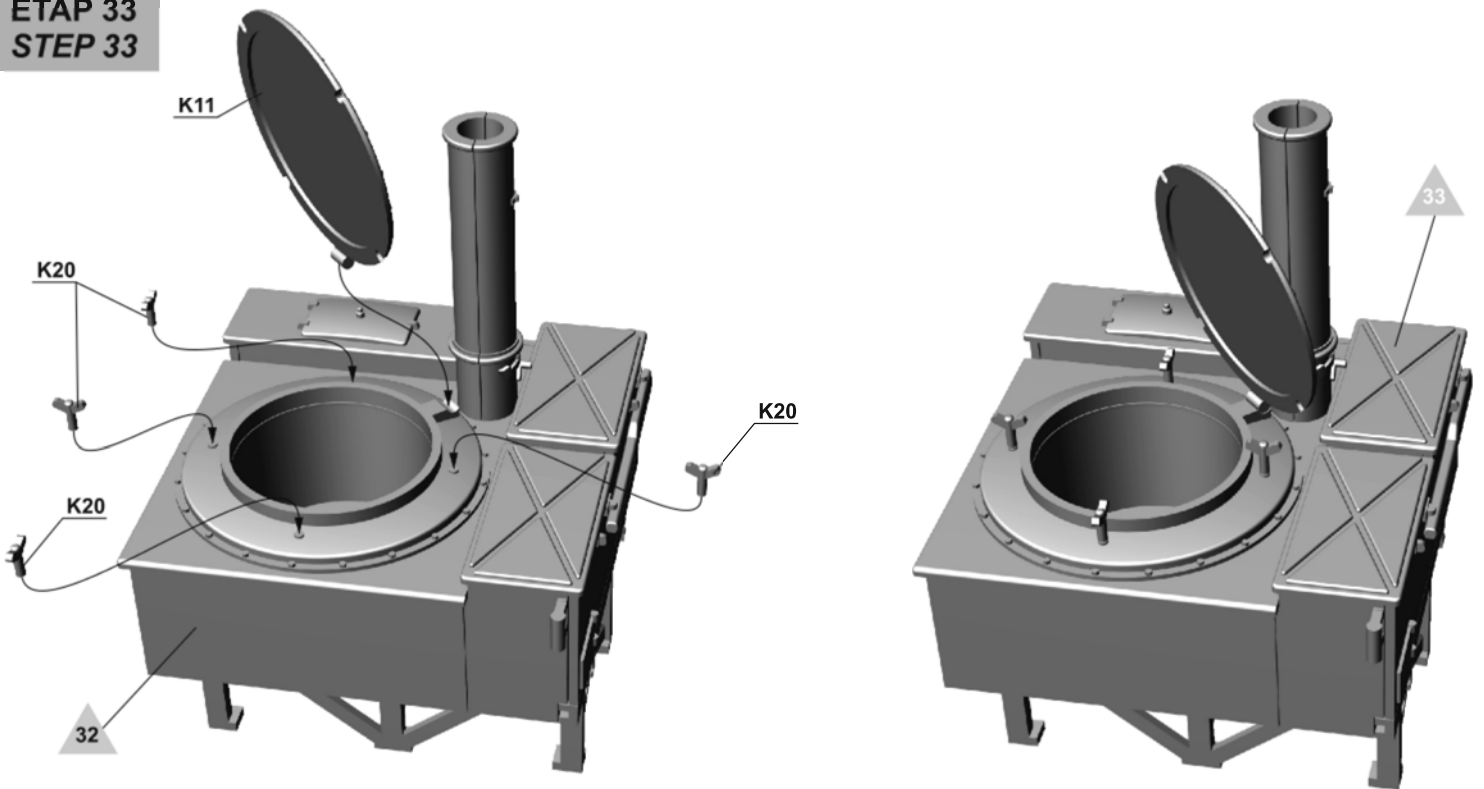

otwarta pokrywa kotła  
*boiler cover open*



zamknięta pokrywa kotła  
*boiler cover closed*

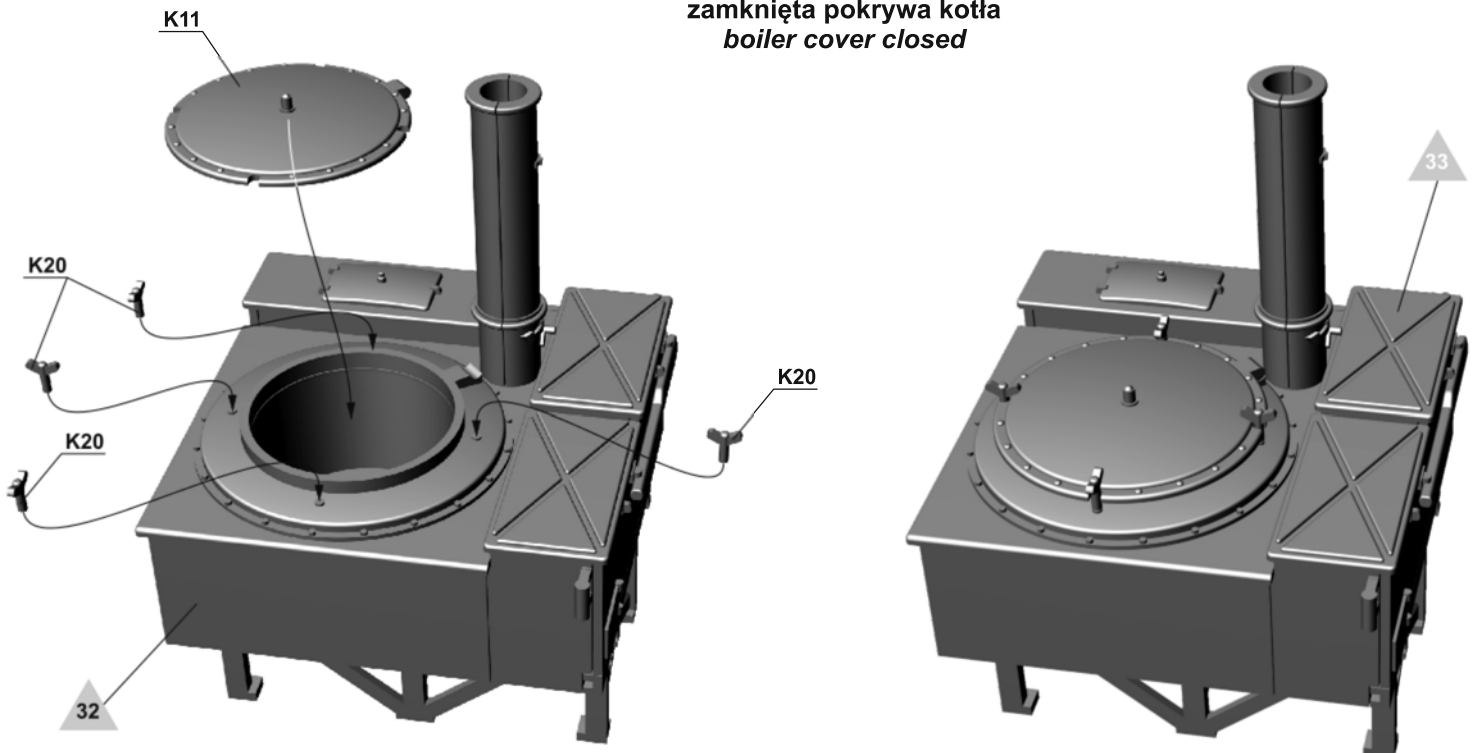

**ETAP 34**  
**STEP 34**

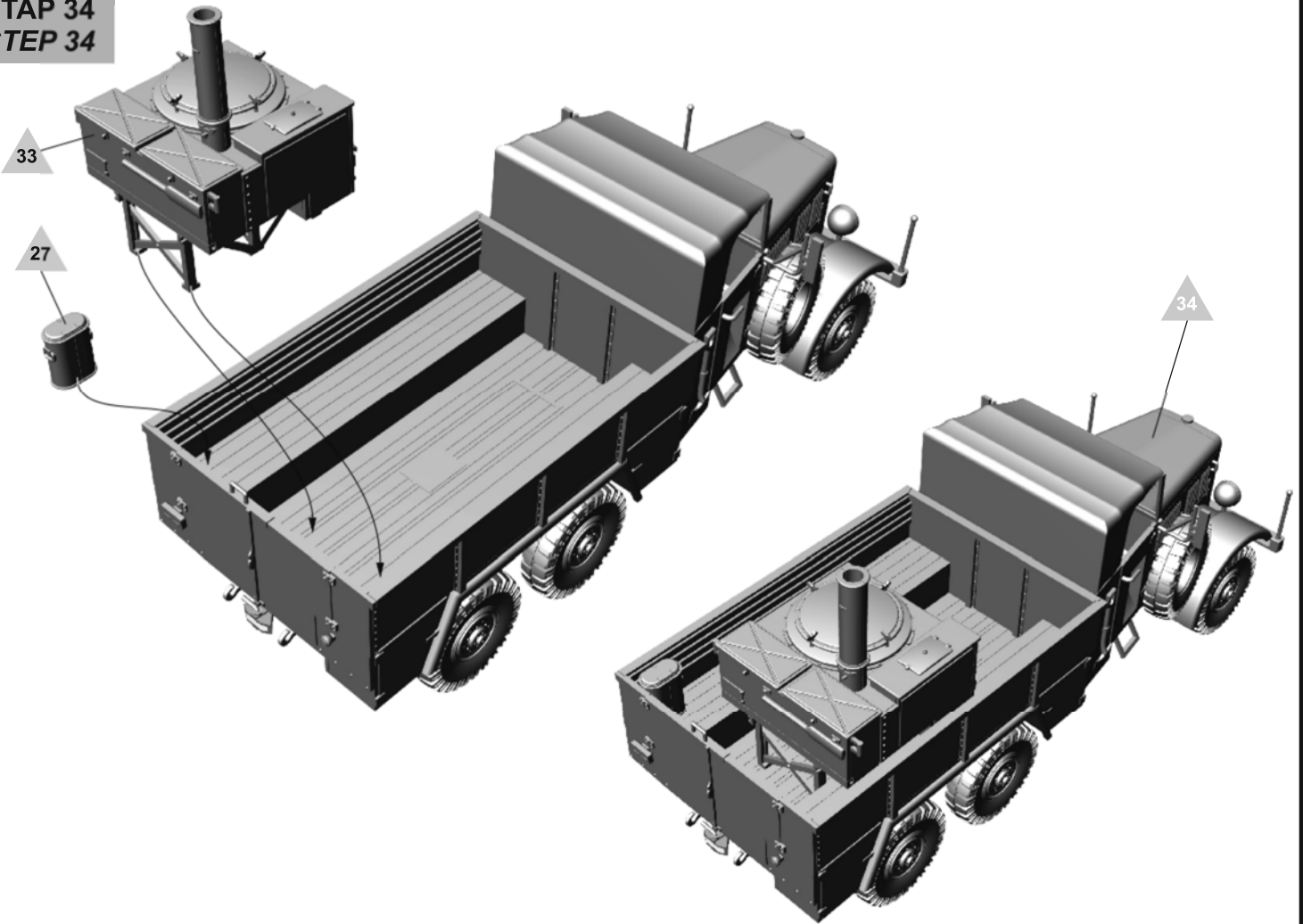

**WYKONANY MODEL**  
**FINISHED MODEL**

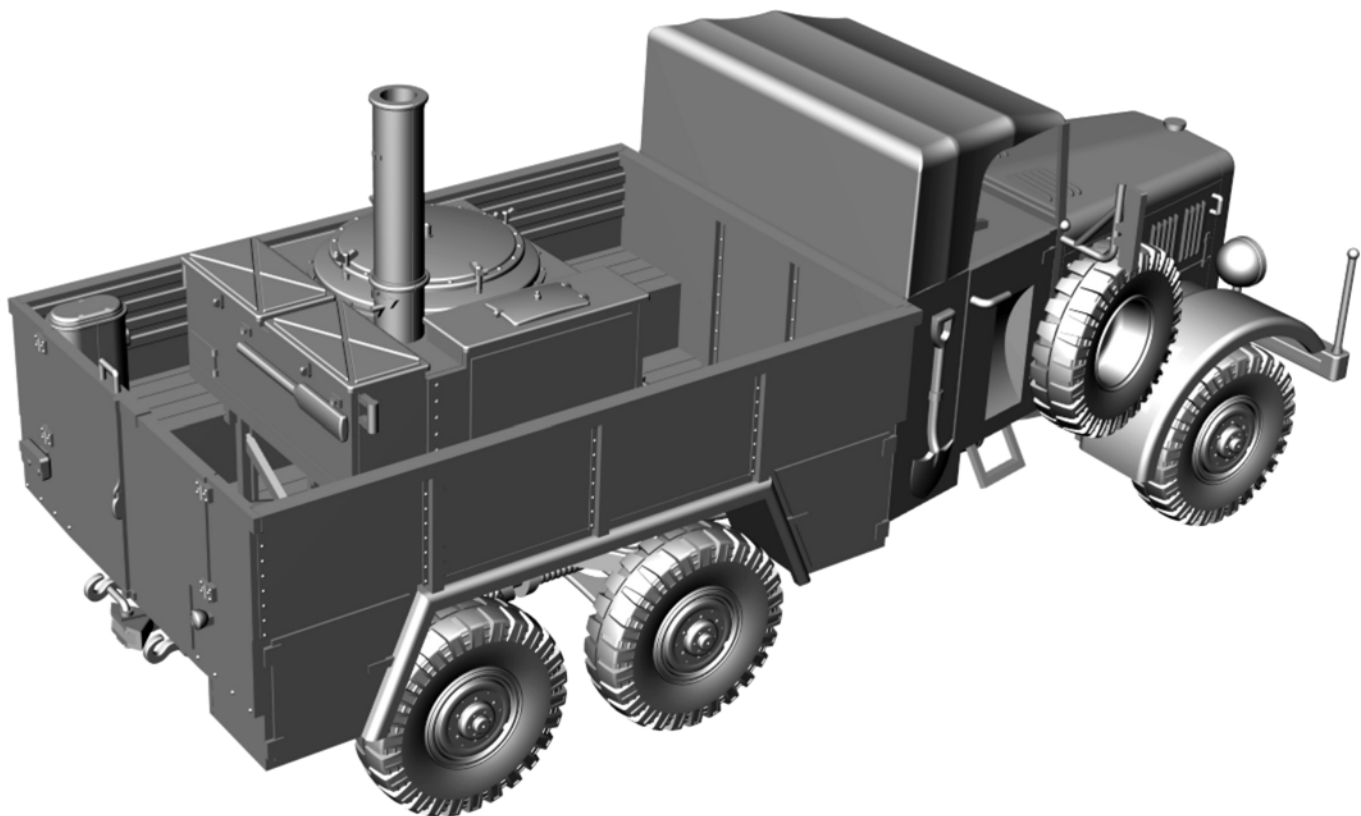

**MALOWANIE I KALKOMANIE**  
**COLOURS AND DECALS**

Einheitsdiesel z kuchnią polową Hf. 14 z Kompanii  
Przeciwpancernej 10 Dywizji Zmotoryzowanej  
Front Wschodni, lato 1941  
*Einheitsdiesel with field kitchen Hf. 14 from AT  
Company of 10th Motorized Infantry Division  
Eastern Front, summer 1941*

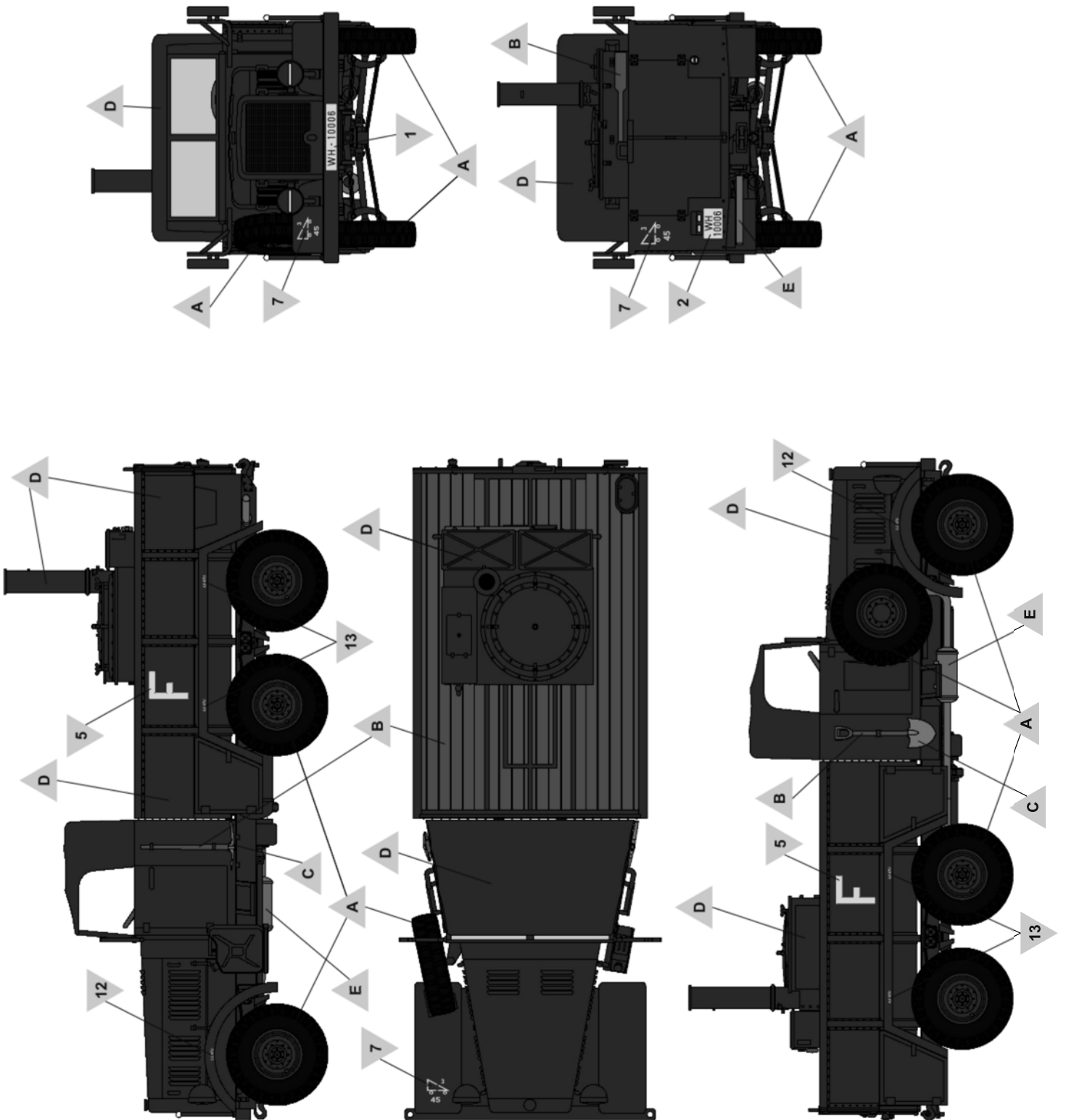

**MALOWANIE I KALKOMANIE**  
**COLOURS AND DECALS**

Einheitsdiesel z kuchnią polową Hf. 14 z Plutonu  
Piechoty Zmotoryzowanej 3 Dywizji Zmotoryzowanej  
Operacja Barbarossa, Rosja, lato 1941  
*Einheitsdiesel with field kitchen Hf. 14 from  
Motorized Infantry Platoon of 3rd Motorized Infantry  
Division  
Operation Barbarossa, Russia, summer 1941*

